

## Frobisher Rooms Level 4

Barbican Centre  
Silk Street  
London EC2Y 8DS  
Tel 020 7382 7043  
businesses@barbican.org.uk  
www.barbican.org.uk

### facilities

available at Frobisher Reception

- free wi-fi
- photocopying service
- staffed secure cloakroom
- toilet facilities including accessible wc
- lounge seating

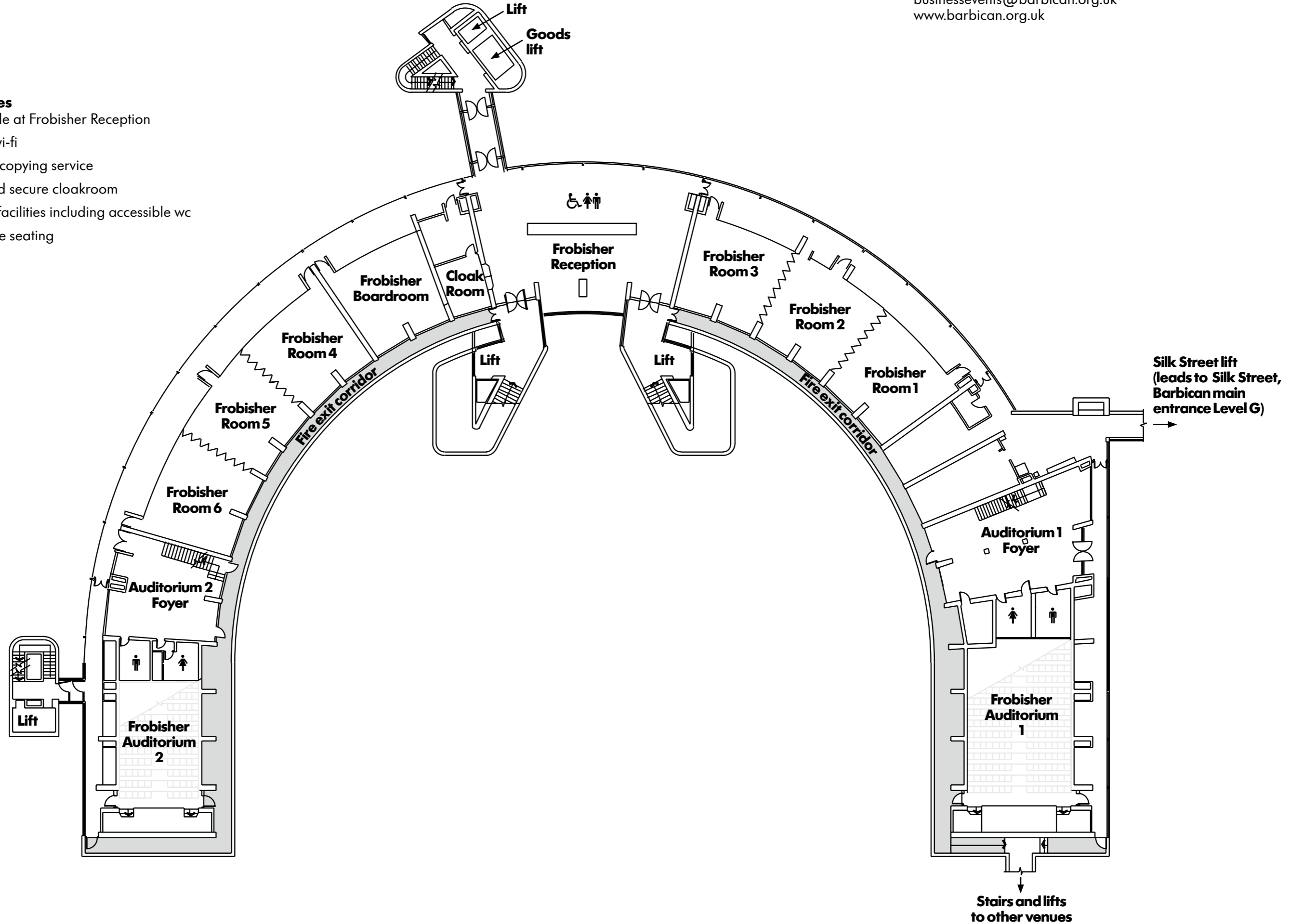

## Frobisher Room Single Room Level 4

Barbican Centre  
Silk Street  
London EC2Y 8DS  
Tel 020 7382 7043  
businesses@barbican.org.uk  
www.barbican.org.uk

### capacity

theatre style 50 max  
classroom style 24 max  
u-shape style 20 max  
boardroom style 16 max

### dimensions

area 72m<sup>2</sup> (775 sq.ft.)  
width 8m (26'3")  
length 9m (29'6")  
height 4m (13'2")

floor loading 100lbs/sq.ft.

### venue facilities

- free wi-fi
- flown projector with motorised screen (10'x8')
- natural daylight, blackout blinds, dimmable lighting and comfort cooling
- directional signage
- accessible via passenger lifts, stairs and goods lift
- frobisher rooms are all wheelchair accessible

Plan to be used as a guide only.  
each grid square represents 1m<sup>2</sup> (approx).

Fire exit  
and main entrance

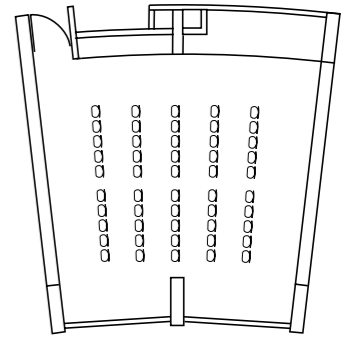
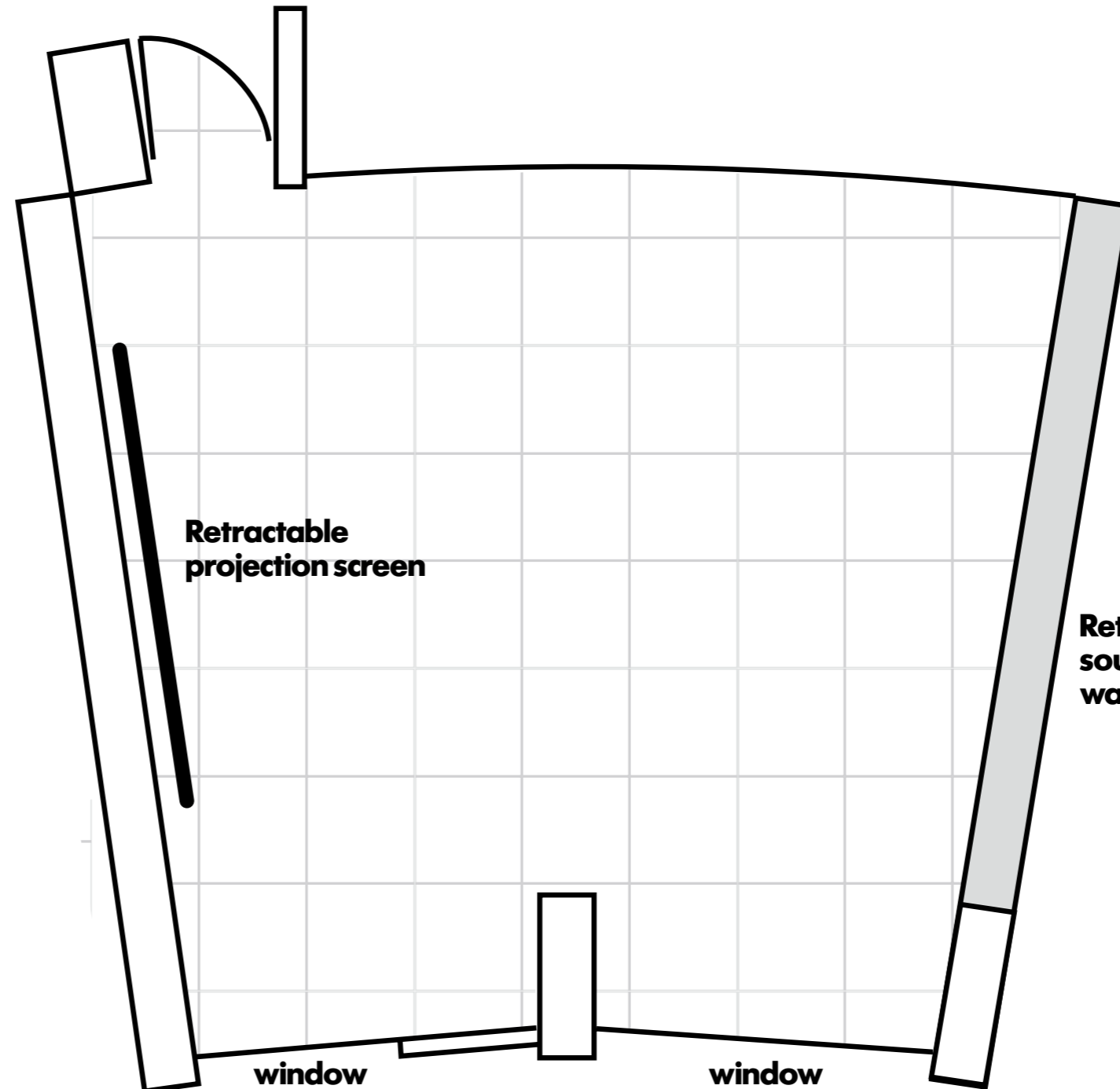

Theatre style

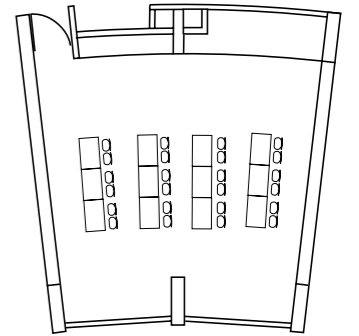

Classroom style

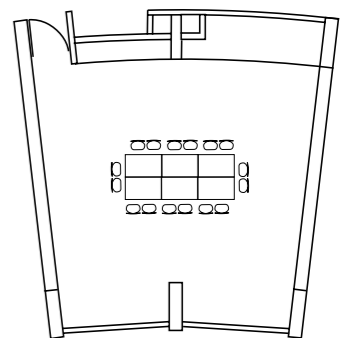

Boardroom style

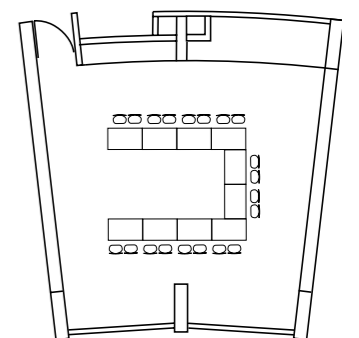

U-shape style

## Frobisher Room Two rooms linked Level 4

Barbican Centre  
Silk Street  
London EC2Y 8DS  
Tel 020 7382 7043  
businesses@barbican.org.uk  
www.barbican.org.uk

### capacity

theatre style	110 max
classroom style	60 max
u-shape style	44 max
cabaret style	56 max

### dimensions

area	144m <sup>2</sup> (1,550 sq.ft.)
width	8m (26'3")
length	18m (59')
height	4m (13'2")

floor loading 100lbs/sq.ft.

### venue facilities

- free wi-fi
- flown projector with motorised screen (10'x8')
- natural daylight, blackout blinds, dimmable lighting and comfort cooling
- directional signage
- accessible via passenger lifts, stairs and goods lift
- frobisher rooms are all wheelchair accessible

Plan to be used as a guide only.  
each grid square represents 1m<sup>2</sup> (approx)

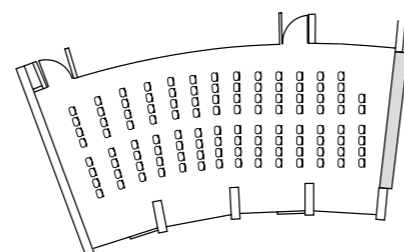
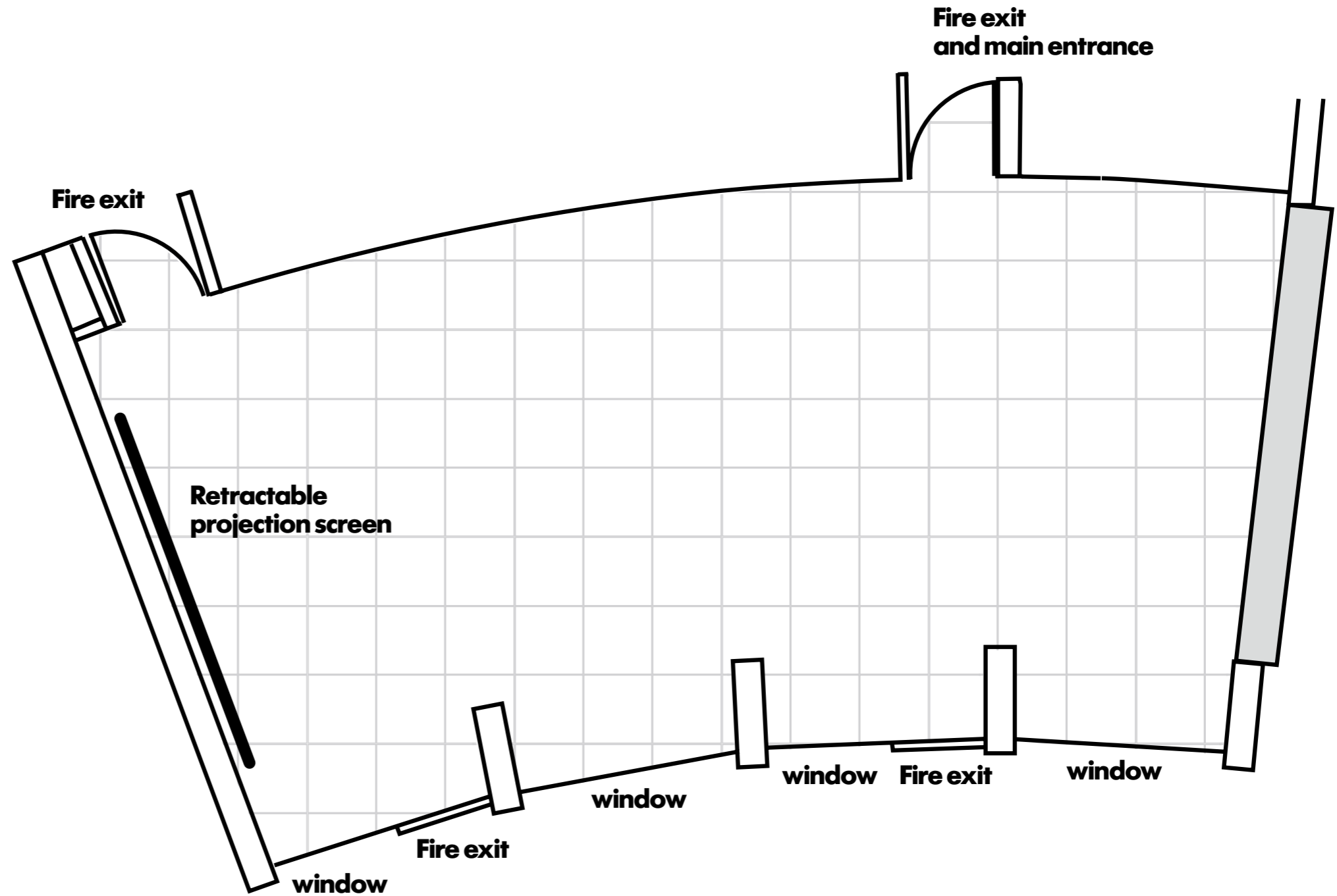

Theatre style

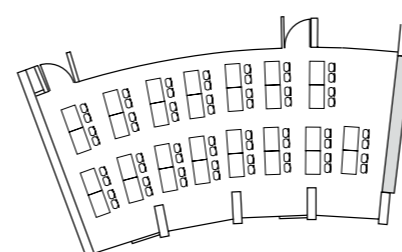

Classroom style

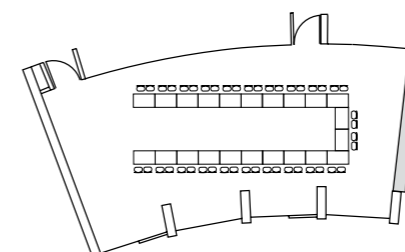

U-shape style

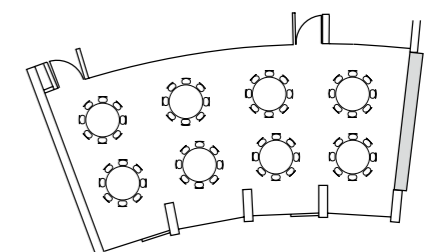

Cabaret style

## Frobisher Room Three rooms linked Level 4

Barbican Centre  
Silk Street  
London EC2Y 8DS  
Tel 020 7382 7043  
businesses@barbican.org.uk  
www.barbican.org.uk

### capacity

theatre style 170 max  
classroom style 100 max  
cabaret style 96 max

### dimensions

area 216m<sup>2</sup> (2,325 sq.ft.)  
width 8m (26'3")  
length 27m (88' 6")  
height 4m (13'2")

floor loading 100lbs/sq.ft.

### venue facilities

- free Wi-Fi
- flown projector with motorised screen (10'x 8')
- natural daylight, blackout blinds, dimmable lighting and comfort cooling
- directional signage
- accessible via passenger lifts, stairs and goods lift
- frobisher rooms are all wheelchair accessible

Plan to be used as a guide only.  
Each grid square represents 1m<sup>2</sup> (approx)

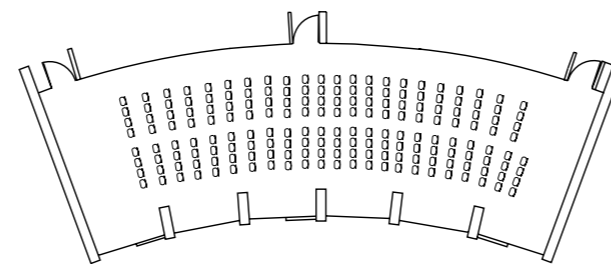
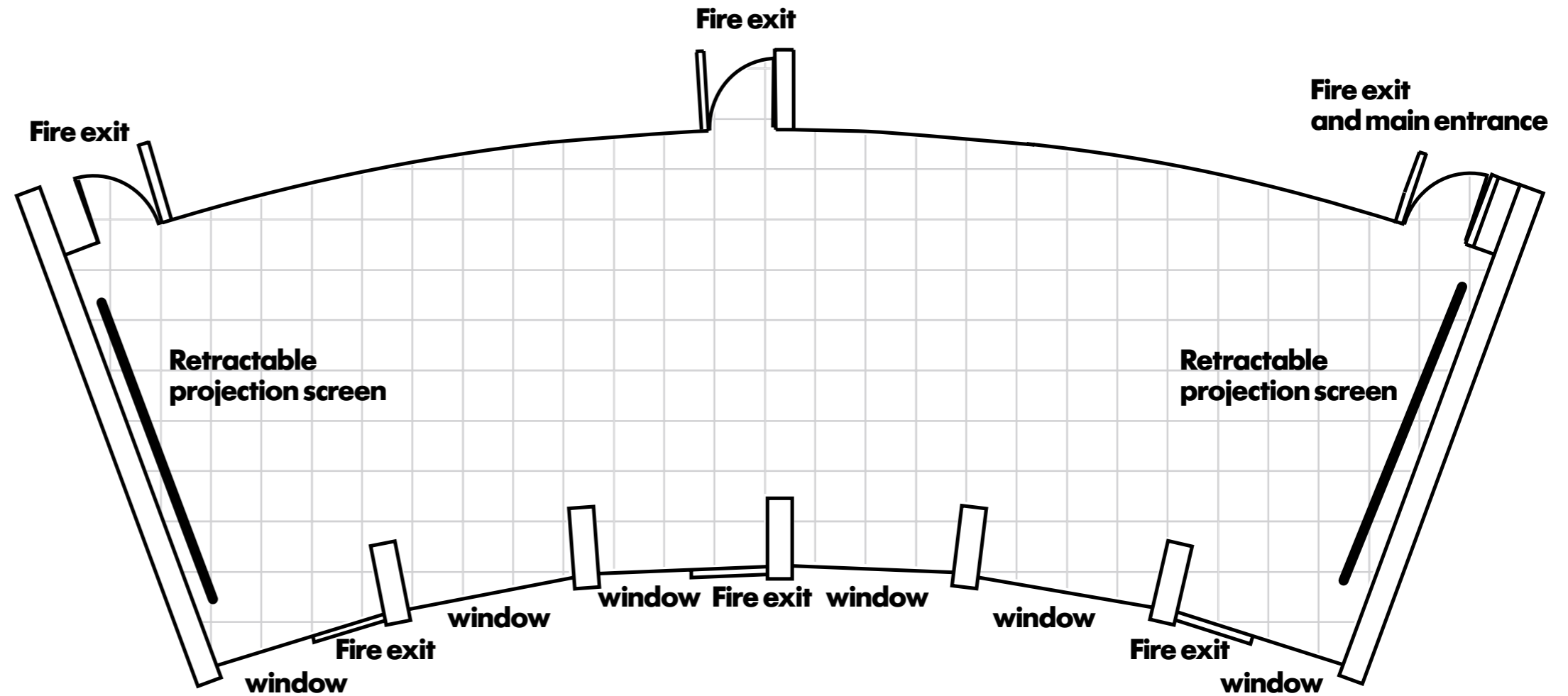

Theatre style

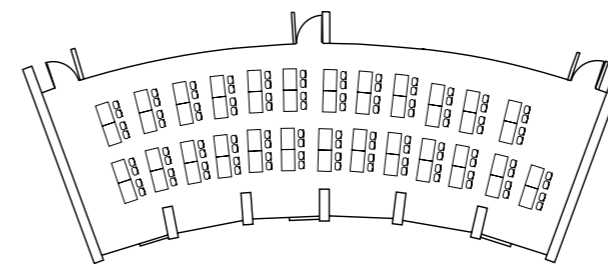

Classroom style

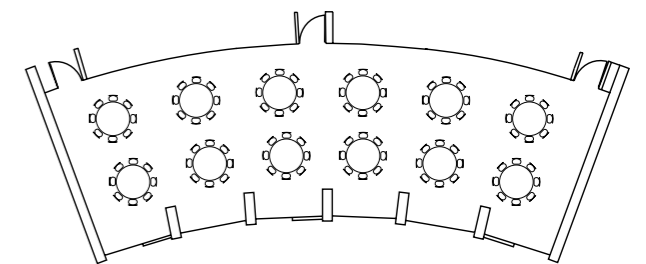

Cabaret style

## Frobisher Boardroom Level 4

Barbican Centre  
Silk Street  
London EC2Y 8DS  
Tel 020 7382 7043  
conference@barbican.org.uk  
www.barbican.org.uk

### capacity

boardroom 20 max

### dimensions

area 68m<sup>2</sup> (732 sq.ft.)  
width 8m (26'3")  
length 8.5m (27'11")  
height 4m (13'2")

floor loading 100lbs/sq.ft.

### venue facilities

- free wi-fi
- flown projector with motorised screen (10'x8')
- dedicated boardroom table with black leather armchairs
- natural daylight, blackout blinds, dimmable lighting and comfort cooling
- directional signage
- accessible via passenger lifts, stairs and goods lift
- wheelchair accessible

Plan to be used as a guide only.  
Each grid square represents 1m<sup>2</sup> (approx).

**Fire exit  
and main entrance**

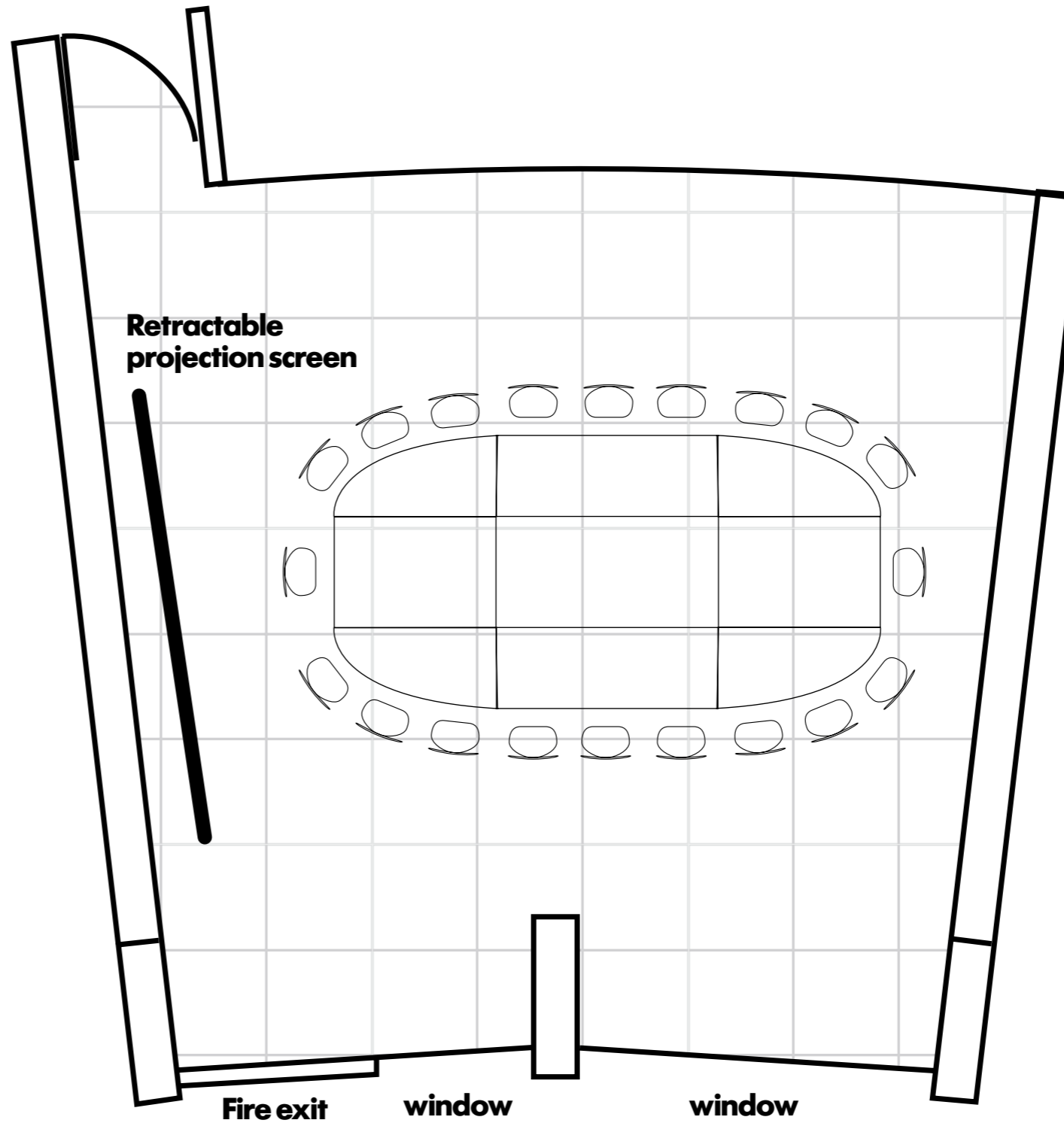

## Frobisher Auditorium 1 Level 4

### capacity

total 243 plus 3 wheelchair positions

### stage dimensions

area 12.2m<sup>2</sup> (131 sq.ft.)  
width 7.3m (22'2")  
length 1.6m (5'6")  
height MAX 4m (13'1")

### facilities

- free Wi-Fi
- perlux cinema screen (21' x 9'6" with variable side, top and bottom masking)
- full facilities for video and data projection
- dedicated technician
- fixed stage of 11.6 m<sup>2</sup>
- integrated sound system
- stage lighting
- induction loop
- air conditioning
- private foyer area
- accessible via passenger lifts, stairs and goods lift
- wheelchair accessible for delegates

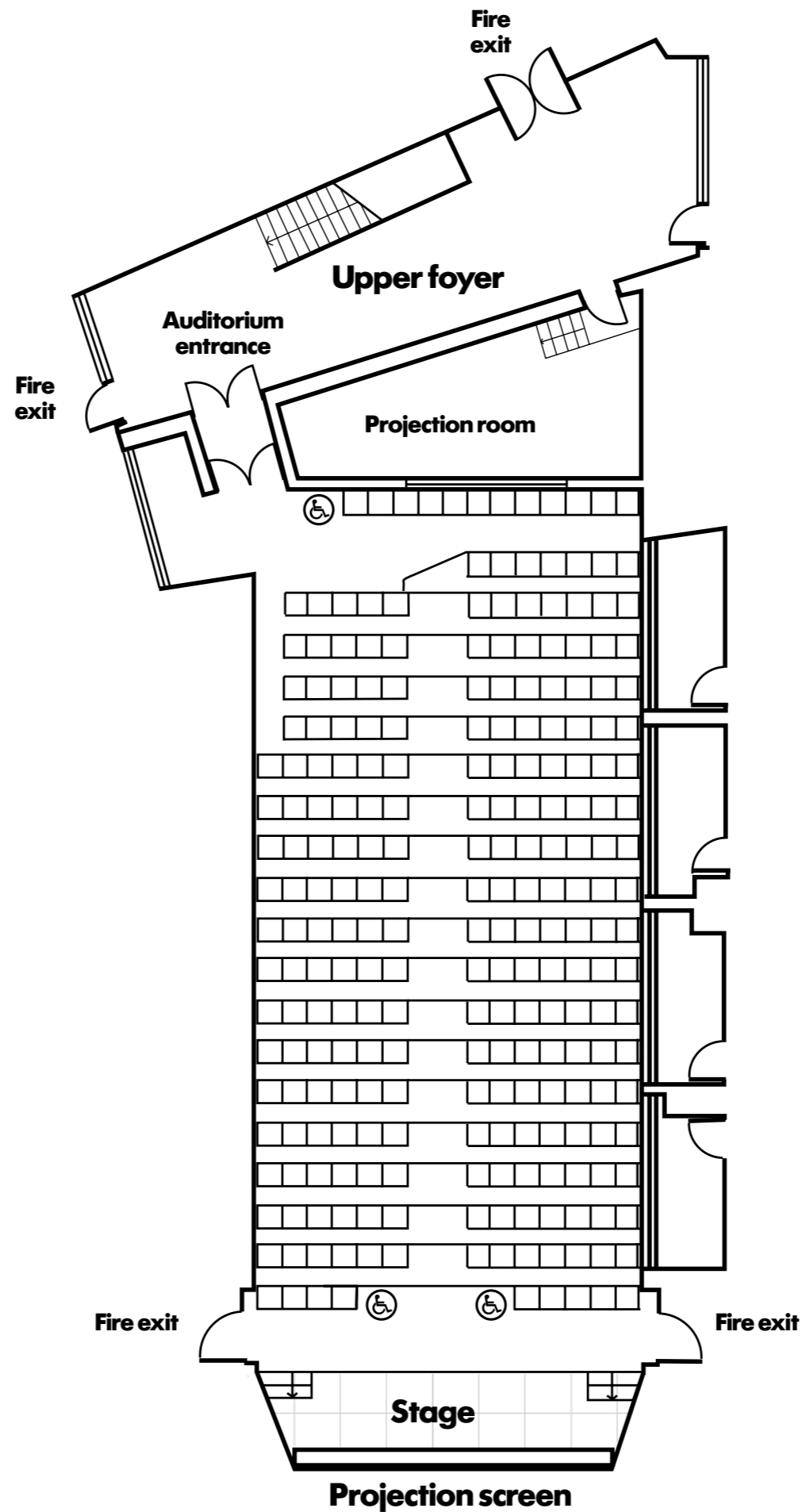

Barbican Centre  
Silk Street  
London EC2Y 8DS  
Tel 020 7382 7043  
businesses@barbican.org.uk  
www.barbican.org.uk

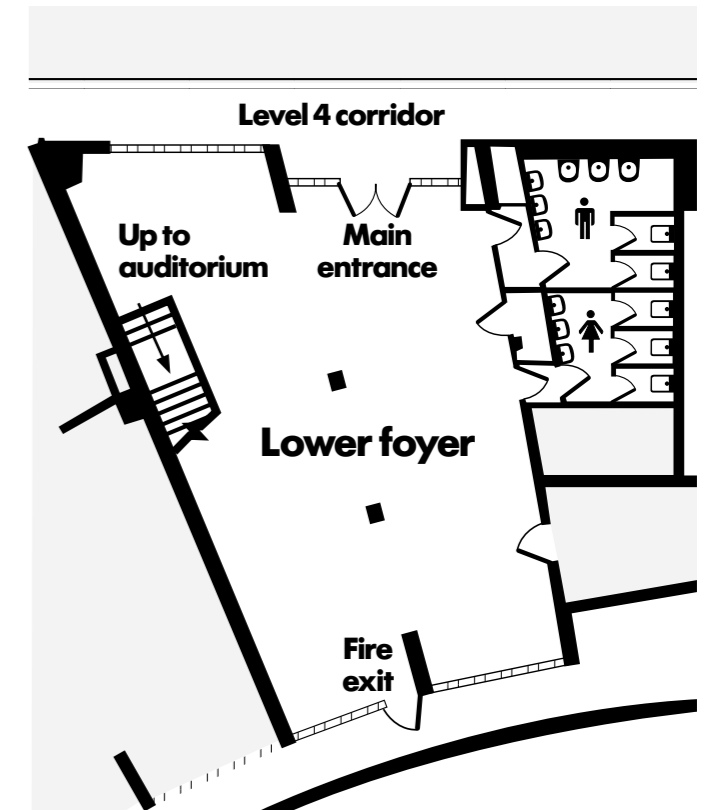

## Frobisher Auditorium 2 Level 4

### capacity

total 152 plus 1 wheelchair position

### stage dimensions

area 8.9m<sup>2</sup> (96 sq.ft.)  
width 5.3m (17'7")  
length 1.6m (5'6")  
height max 4m (13'1")

### facilities

- free wi-fi
- perlux cinema screen (16'4" x 8'2" with variable side, top and bottom masking)
- full facilities for video and data projection
- dedicated technician
- fixed stage of 8.5m<sup>2</sup>
- integrated sound system
- stage lighting
- induction loop
- air conditioning
- private foyer area
- accessible via passenger lifts, stairs and goods lift
- wheelchair accessible for delegates

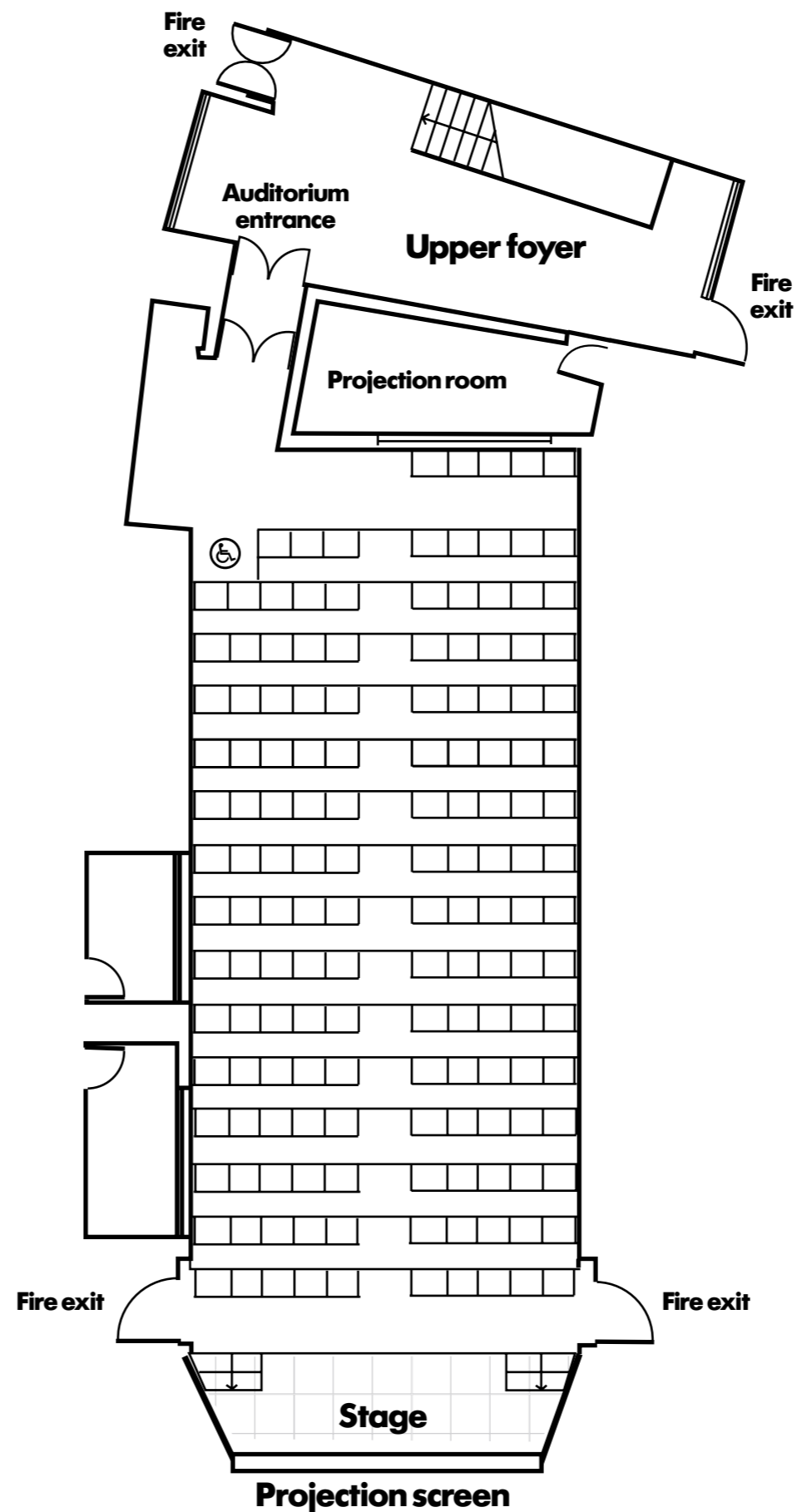

Barbican Centre  
Silk Street  
London EC2Y 8DS  
Tel 020 7382 7043  
businesses@barbican.org.uk  
www.barbican.org.uk

