

Barbican Renewal

Report of public consultation held 19 May – 2 June
2025

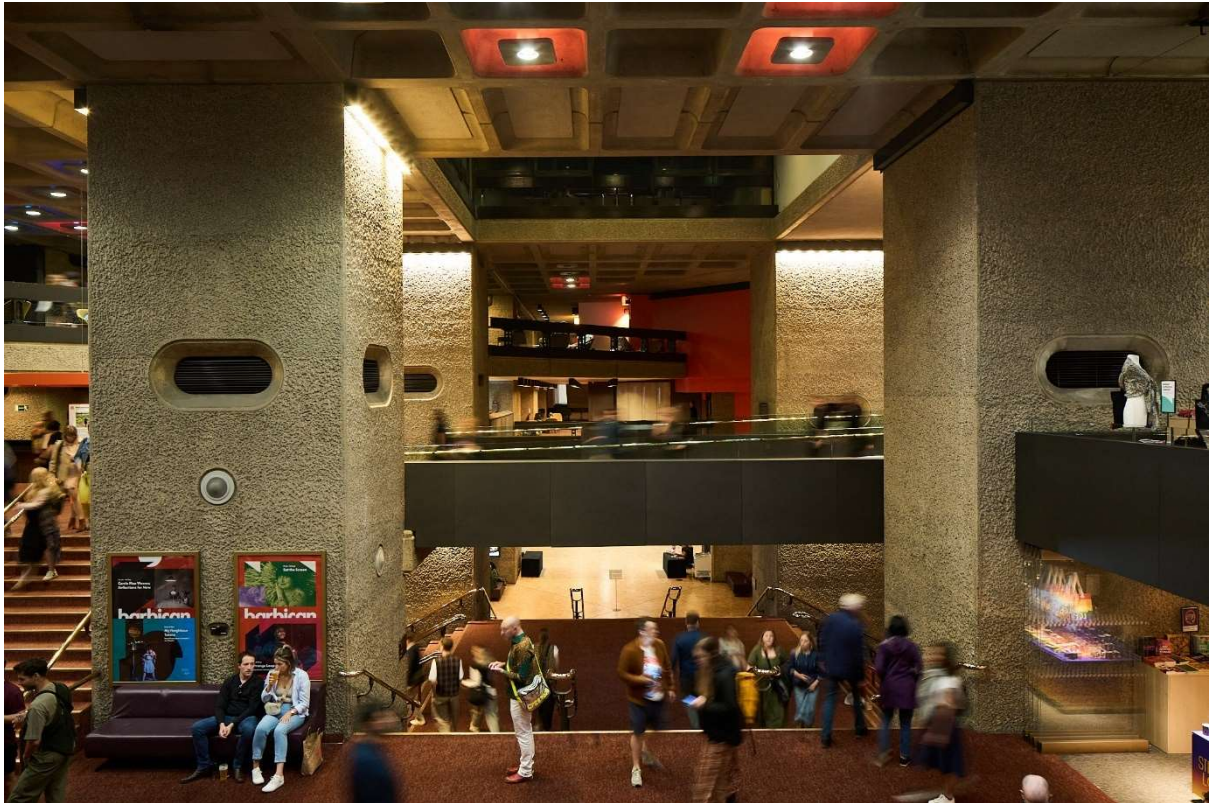

Photo by Dion Barrett

July 2025

Table of contents

Introduction	3
Summary of consultation activity	4
Analysis of responses	5
• Renewal overall	6
• Toilets	13
• Foyers	17
• Lakeside	23
• Conservatory	27
Next steps	31
Appendix: consultation publicity	32

Introduction

Barbican Renewal is the Barbican Centre's plan to ensure every part of its iconic site is restored, revitalized and relevant for future generations. At the heart of Renewal is a commitment to celebrating the architectural vision and heritage of the Centre, with a programme of sensitive conservation and upgrade to bring the buildings back to their best, while also delivering a place that is truly inclusive, sustainable and resilient.

After more than 40 years of intensive activity, the Centre is now in urgent need of upgrade and improvement. Barbican Renewal will celebrate and enhance the Centre's unique architecture and design heritage, ensuring it can be enjoyed by future generations. This includes revitalising existing spaces, improving access for all visitors, and making the building more efficient and sustainable.

Barbican Renewal is already underway, with essential improvements being made to systems and visitor facilities. The next phase of work from 2025-2030 proposes complete restoration and refurbishment of key public spaces including the unique brutalist Foyers, Lakeside Terrace, and Conservatory. Subject to planning permission, construction will begin in 2027 with this first phase complete in 2030, ahead of the Barbican's 50th anniversary.

This report outlines the activity and responses to a public consultation exercise held from 19 May to 2 June 2025. The following sections describe first how the consultation was conducted before presenting the consultation feedback alongside project responses across five themes:

1. Renewal overall
2. Toilets
3. Foyers
4. Lakeside
5. Conservatory

Summary of consultation activity

The consultation presented information in themes of Renewal overall, Foyers, Lakeside and Conservatory. The bulk of the consultation material comprised a report of an earlier consultation exercise held in January-February 2025 along with responses to issues raised by respondents to that consultation and design updates. This enabled participants to understand what had come from the earlier consultation and how designs had progressed in the interim, whether in response to consultation feedback or for any other reason. As part of the consultation, new CGI imagery was provided to help respondents visualise the changes.

The material was made available online at barbican.org.uk/renewal and supplemented by a range of meetings and events, as follows:

- A webinar held and recorded on the day the consultation launched with more than 70 attendees.
- Four drop-in sessions of 150 minutes each, attended by the project team and architects, held in different spaces within the Centre, at a variety of days and times throughout the consultation period.

These activities were widely publicised to the local community, stakeholders and Centre audiences using a range of methods including emails, digital newsletters (from the Centre and City of London Corporation), letter drops, flyers and posters. See appendix 1 for details and examples of the activity.

People were able to respond to the consultation via a range of methods:

- An online survey at barbican.org.uk/renewal
- A paper version of the survey available in the Centre and posted on request
- By email to barbicanrenewal@barbican.org.uk or letter to the Centre

The next section of the report presents the analysis of quantitative and qualitative responses to the consultation.

Analysis of responses

In total, 1,908 consultation responses were received as a mix of online survey responses (1,568), paper survey responses (12) and emails (328).

The consultation survey asked questions across four categories:

1. The Renewal programme overall
2. Foyers
3. Lakeside
4. Conservatory

For each category, respondents were asked to answer a closed question, expressing their view of the proposals on a five-point scale from strongly disagree to strongly agree. They were also invited to submit any other comments in a free text box. Respondents were free to choose which of the questions they answered, although the online version of the survey required a response to the first closed question to avoid blank responses being received.

All the responses received, including some which were sent separately by email or letter rather than through the survey, have been analysed, coded and grouped into themes. These are reported in the following sections of the report along with a response from the project team.

Renewal overall: consultation findings and updates

Across the Renewal programme as a whole, 91% of respondents agreed or strongly agreed with our proposals.

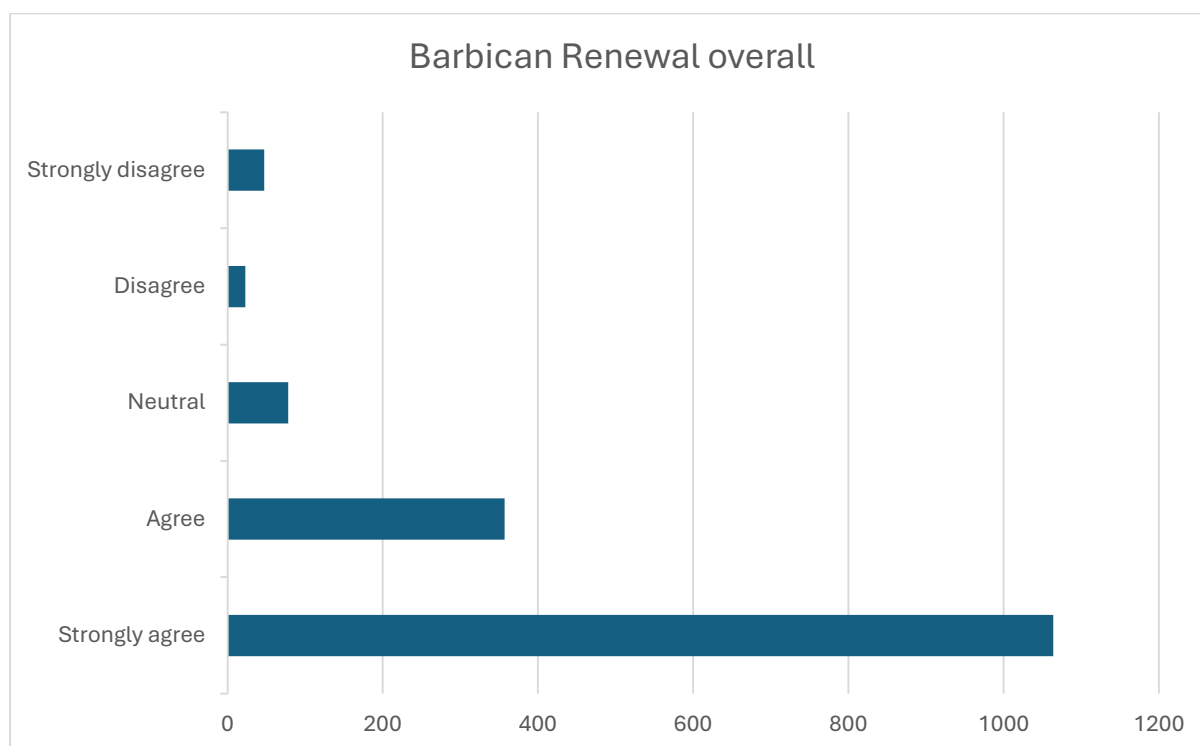

Figure 1: chart of responses to the Renewal programme overall

In written feedback it is of note that apart from three categories (general support, accessibility and inclusion) the remaining comments were made by very low numbers of respondents, each in single figures. The comments are summarised below, with responses and updates from the project team, in alphabetical order by category of issue raised.

Accessibility:

Summary of feedback	Project response
<p>There was a significant degree of support for plans to improve accessibility, including new lifts, automatic doors, different types of seating and toilets suitable for all needs.</p> <p>In addition the following specific comments and suggestions were made:</p> <ul style="list-style-type: none"> • General principle that this should be a top priority • That language needs to be welcoming and accepting alongside the building • Suggestions for lowered counters, accessible working areas for disabled performers and provision of accessibility aids (not specified) 	<p>The support is noted and 'design for all' is one of the four key principles the Renewal project is working to. We have recently established an Access and Inclusive Design Advisory Group which will work closely with us throughout the rest of Phase 1 to ensure that the detailed design meets our aspirations for access and inclusion. This includes disabled artists/performers who have worked at the Centre.</p>

Architecture and heritage:

Summary of feedback	Project response
<p>Comments were made that the Centre's architecture should be celebrated and that the Brutalist character of the building must remain.</p> <p>Comments also emphasised the importance of the Centre's architectural heritage and offered support and/or suggestions for protecting this:</p> <ul style="list-style-type: none"> -Maintaining or restoring original finishes, fixtures and fittings -Ensuring that the enjoyment of discovering the building is not lost in changes to make it more accessible 	<p>One of our four design principles for Renewal is 'repair and conserve: celebrate the Barbican's iconic architecture, honouring the bold vision at the heart of the Centre's development'. This principle underpins all the Renewal proposals, with sensitive changes being made only where they will enhance the building and visitor experience and meet modern standards for accessibility and sustainability.</p> <p>Renewal will retain and restore as many original fixtures and fittings as possible, and visitors should expect to see key features such as the brass handrails and door furniture, wood block flooring, terrazzo restored and retained, along with the monumental hand-hammered concrete. Where changes are being introduced, some of these will go back towards the original design (e.g. the doors to Lakeside, lighting fixtures) while new additions such as the proposed Foyer lift will be designed sympathetically to the originals.</p>

Doors:

Summary of feedback	Project response
<p>A respondent expressed opposition to changing the doors, considering them part of the iconic architecture of the Centre.</p>	<p>Many of the doors and their fittings are part of the historic design of the Centre and will not be changed. Our main proposal for doors is to replace those between the Level G Foyer and the Lakeside, which are not of original design. The original doors were in a single layer and highly transparent, creating a sense of connection between the indoor and outdoor spaces. The current design of rows of narrow, heavy casement doors, with thick framing and internal lobbies is detrimental to the aesthetic and user experience of the Foyers. Our proposal is to return to something as close to the original as possible, while meeting modern standards for accessibility and sustainability by using automated sliding doors and a glazing system that will reduce heat loss and gain.</p>

General support for proposals:

Summary of feedback	Project response
---------------------	------------------

The largest group of comments expressed general support for the need for Renewal and the proposals overall, including the design principles.	The responses are noted.
--	--------------------------

Impacts - construction:

Summary of feedback	Project response
<ul style="list-style-type: none"> A suggestion was made to close the Centre and do all the work in one go to reduce the duration of work and not have works happening while people are trying to use and enjoy the space A Barbican Estate resident expressed concern about noise and intrusion of building works A request was made to maintain access to the Library throughout the works 	<p>We are aware that Barbican Renewal is happening alongside many other changes in the local area, including improvements to the Barbican residential estate, the proposed 'healthy neighbourhood' scheme affecting surrounding streets and developments of neighbouring sites. We are working closely with colleagues in the City of London, including with the Barbican Estate Office and City Surveyors team to coordinate work and minimise the impacts of multiple projects happening simultaneously.</p> <p>We are aiming to keep the Centre open throughout Renewal although different parts of it will need to close at times. We do not yet have details of the construction programme, though we are committed to working closely with residents and other local stakeholders to find ways to keep disruption to a minimum while enabling us to complete the projects.</p>

Inclusion:

Summary of feedback	Project response
A number of comments referenced the importance of, and support for, making the Centre more inclusive and welcoming to all. Some of these specifically mentioned trans and non-binary people and disabled people.	The comments are noted and we aim to create a fully inclusive environment through Renewal, particularly in enacting our design principles of 'design for all' and 'reactivate space', with improved access, circulation, wayfinding and facilities, alongside revitalising underused spaces - opening them up to the public and delivering creative offers that speak to new audiences.

Maintenance:

Summary of feedback	Project response
A small number of responses highlighted the need for ongoing repairs to ensure the longevity of Renewal.	The feedback is noted and we agree that ongoing maintenance will be essential, although the large capital investment into building fabric and modern systems will reduce the need for ongoing running repairs in the coming years, compared with the current situation after more than 40 years of heavy use of the building.

Miscellaneous/other:

Summary of feedback	Project response
<ul style="list-style-type: none"> Two comments expressed scepticism that the proposals would come to fruition. One was concerned that the proposal to 'remove unnecessary clutter' is vague and more detail is required A concern was raised as to whether the quality of work and materials would match the high standards of the original Barbican Centre 	<p>Subject to planning permission, Phase 1 of Renewal is 80% funded by the City of London Corporation, and the Centre is fundraising for the remaining sum. We are confident that the programme is deliverable in the timeframes we have set out.</p> <p>More detail of all our plans is now available in the planning application.</p> <p>We have planned and budgeted to ensure that the design, work and materials are on par with the original high quality and long-lasting design of the Centre.</p>

Planting:

Summary of feedback	Project response
<ul style="list-style-type: none"> Three comments expressed general support for increasing planting and green areas across the site. One suggested learning about trees and tree pits from colleagues in the City of London as their experience will be relevant to Renewal's design. Two comments asked about specifics of planting and particularly suggested not introducing 'aggressive' plants such as fatsia, mahonia and euphorbia. 	<p>The comments and support have been noted and we are working closely with colleagues in the City of London Corporation throughout Renewal.</p> <p>More details of the planting proposals will be developed in the coming months and specifics are not currently available.</p>

Public access:

Summary of feedback	Project response
<p>A small number of respondents made comments in relation to use of the Centre's spaces after Renewal:</p> <ul style="list-style-type: none"> Some queried the extent to which children should be accommodated and wanted the Centre to remain a place mainly for adults Two wanted to ensure that informal uses and activities by individuals and community groups would still be welcomed and not pushed out by Barbican events One suggested having 'adults only' times some evenings 	<p>As a public building the Barbican Centre has always welcomed a wide range of audiences, visitors and different uses. Our design principles of 'design for all' and 'reactivate space' signal our intention for this to go further in future. We will continue to ensure that families and small children are welcome and will be better accommodated in future, but there will also be times of day, activities/programming and parts of the Centre (e.g. Martini Bar) that are more suited to adult audiences. We also intend to continue to strengthen our relationship with a wide range of local communities both through our organised 'Take Part' programming and through the public areas of the building being, in future, as now, welcoming for self-organised meet-ups and creative activities.</p>

Seating and furniture:

Summary of feedback	Project response
A response suggested providing more seating at the Centre.	The Renewal programme will include significant improvements to furniture, with more places to sit and better and more flexible furniture for a range of needs and uses across the site. The design of this will be developed at a later stage of the project and is not subject to planning permission, so no further details are available currently.

Sustainability:

Summary of feedback	Project response
Responses offered support for the focus on sustainability, reducing energy use and increasing biodiversity.	The support is noted.

In addition to the above there were a small number of responses which raised issues related to the consultation process and issues which are out of scope of Phase 1 of Renewal, which was the subject of the consultation. These are reported as follows:

Consultation:

Summary of feedback	Project response
<p>A small number of responses raised concerns with the content provided in the consultation, specifically that:</p> <ul style="list-style-type: none"> -The online survey should have had links to the proposed changes for ease of reference -The information provided was too vague or not detailed enough to be able to comment -There should have been more images and diagrams -There was too much text and this is inaccessible to some -The website was difficult to navigate to find details of the proposals 	The comments are noted and will be reflected on in development of future consultations. Full details of proposals are now available in support of the application for planning permission, which is subject to a statutory public consultation run by the City of London Corporation.
Concern that the survey results may be influenced by campaigners (some responses specified that the consultation was being targeted by anti-trans campaigners)	There was some evidence of campaigning activity influencing consultation responses, however all responses are analysed on the merits of the issue raised rather than the motivation of the respondent, and have been responded to in this report.

Out of scope of the Phase 1 proposals:

Summary of feedback	Project response
<p>Issues were raised in relation to accessibility:</p> <ul style="list-style-type: none"> • Concern at lack of disabled parking for high wheelchair accessible vehicles within the car parks. This means people 	These points are not in scope of Phase 1 of Renewal or this consultation, however they have been raised with relevant colleagues in the Centre to see if it is possible to address them outside of the Renewal programme.

<p>have to park on street and navigate narrow pavements and road crossings</p> <ul style="list-style-type: none"> • Suggestion that the Barbican should have more captioned performances and/or handheld captioning devices 	
A suggestion to provide accommodation rental units for non-UK members	The Centre does not have available space to provide accommodation on site.
A request from a Barbican resident to clarify that leaks, lighting and dust in the car parks will be handled by the Barbican Estate Office	We work closely with colleagues at the Barbican Estate Office and will liaise closely on construction impacts. Responsibility for the car parks will remain as currently divided between those operated by the Centre for its visitors and those for Estate residents.
A comment that there is lack of examples provided of how the need to connect with other major developments in the area has shaped the plan	
<p>Comments about other parts of the Centre needing Renewal including:</p> <ul style="list-style-type: none"> • Improvements to the performance spaces and venues • A specific comment about the Hall needing cosmetic and acoustic improvements • A request to refresh the Members' lounge and improve the seating • Concern about lack of plans for the Exhibition Halls 	<p>While most of these areas are not currently planning for delivery during the 2025-2030 phase of Renewal the feedback has been logged and will be reviewed as part of future phases that may address some of these issues.</p> <p>There are some works taking place to the artistic venues that are not part of the Phase 1 proposals and do not require planning permission. This includes replacing the air handling systems for the Art Gallery and Hall, back-of-house theatre systems, and upgrades to lifts and existing toilets across the Centre. Further expanded maintenance and improvement projects in these spaces could also be delivered during this first phase of work but are not part of this planning application.</p>
<p>Issues relating to transport:</p> <ul style="list-style-type: none"> • Comments about routes from the nearby Underground stations, including a concern that people should not walk through Beech Street tunnel, that Moorgate should be renamed 'for Barbican' and Barbican renamed Aldersgate Street and that the yellow lines could be re-implemented for on-street navigation • Suggestion for wayfinding across the City for people trying to find the Centre, particularly from London Wall and Aldersgate Street • Separately comments in favour of improvements to cycle parking provision, 	<p>Where some of these issues fall out of the Centre's authority (e.g. wayfinding and routes to and from the Centre on street and via the Tube network) we will be working closely with the relevant authorities on their projects to try and ensure that visitors and audiences benefit from any changes.</p> <p>The comments in relation to cycle parking have been logged and will be reviewed as part of future phases and/or other programmes that might be able to address these issues.</p>

including parking for cargo bikes, and in favour of reducing danger from motor traffic around the venue	
A comment that Members' lounge no longer has soft seating and a request to bring this back	The Members' lounge is not in scope of Phase 1 of Renewal however the feedback has been passed to the relevant team internally.

Toilets: consultation findings and updates

By far the largest source of issues raised in the consultation was proposals for toilets across the Centre. Because of this it is being reported as a separate category (it does not have a separate quantitative question because this was not part of the survey). The large majority of responses focussed on plans to increase the number of toilets overall, with reductions in single sex facilities in parts of the Centre alongside an increase in unisex and accessible toilets in parts of the Centre that are significantly underprovided with facilities. Most of the responses were received via the online survey but in addition 318 emails were received, which are reported below alongside the survey results.

Toilets – accessibility and inclusion:

Summary of feedback	Project response
<p>Numerous comments offered general support for accessible and inclusive toilets that ensure everyone is welcome and able to access the Centre.</p> <p>In addition there were some suggestions for more accessible toilets, including making them larger than the existing ones to allow for wheelchairs to turn comfortably and for Changing Places toilets to be provided on each floor.</p>	<p>The general support for accessible and inclusive toilets has been noted.</p> <p>We propose to add a number of accessible toilets on different floors, which will be designed to modern standards including cubicles for wheelchair users and ambulant disabled people. A Changing Places facility is proposed for the new Level G toilet block in addition to the existing Changing Places facility in the Cinema 2/3 building.</p>

Toilets – support for unisex/gender-neutral toilets:

Summary of feedback	Project response
<p>Over 500 responses were received that made comments in support of unisex/gender-neutral toilets. Specific issues were raised as part of this covering the following topics:</p> <ul style="list-style-type: none"> • Support for trans and non-binary inclusion • Universal cubicles have greater privacy for anyone that needs them (e.g. menstruation, complex needs, stoma-changing, medical conditions) than single-sex toilets • Unisex toilets are easier for parents to accompany children of the opposite sex • People do not have to justify their right to use a particular toilet (e.g. if they do not present visually as being a particular sex/gender) • Unisex single cubicles will reduce queues for women and others that unisex cubicles are more accessible for all • Concern that gender-neutral toilets are proposed to be removed from the Centre 	<p>The issues raised have been noted. Details of our plans for toilets have been made available as part of the planning application, including a full Equality Analysis of the proposals which addresses issues raised in this consultation in more detail, alongside advice and expertise from other sources.</p>

<ul style="list-style-type: none"> Concern that restaurant/café customers will not have access to a gender-neutral toilet other than that designated for disabled users 	
--	--

Toilets – suggestions in relation to unisex/gender-neutral toilets:

Summary of feedback	Project response
<p>A small number of responses made suggestions in relation to unisex/gender-neutral toilets:</p> <ul style="list-style-type: none"> Maintaining separate-sex toilets Making the majority of toilets gender neutral Providing all gender-neutral toilet blocks Including period bins in all cubicles Providing gender-neutral toilets in addition to rather than instead of male and female toilets Providing space for a buggy in women's toilets Providing a mix of self-contained and ordinary cubicles in women's toilets to accommodate different needs Providing a self-contained women's accessible toilet (rather than unisex) to give disabled women the same facilities as others Changing the Cinema 1/Pit Theatre toilets from gender-neutral to single-sex 	<p>The issues raised have been noted. Details of our plans for toilets have been made available as part of the planning application, including a full Equality Analysis of the proposals which addresses issues raised in this consultation in more detail, alongside advice and expertise from other sources.</p> <p>The Cinema 1/Pit Theatre toilets are not in scope of Phase 1 of Renewal, however the substantial changes to toilet provision proposed as part of Renewal will allow us to look at toilet provision holistically across the Centre and make sure we meet the needs of all our visitors, working in line with current legislation.</p>

Toilets – concerns and opposition to unisex/gender-neutral toilets:

Summary of feedback	Project response
<p>Over 400 responses (a mix of survey responses and emails) were received that opposed or raised concerns about plans to reduce the number of single-sex toilets and provide new unisex 'Universal' cubicles. These raised the following specific issues:</p> <ul style="list-style-type: none"> General objection to unisex or gender-neutral toilets Plans are discriminatory against women because the change disproportionately impacts them negatively Objection to reduction in women's single-sex toilets Women need more toilet cubicles available than men Women are more likely to be caregivers for children and older people 	<p>The issues raised have been noted. Details of our plans for toilets have been made available as part of the planning application, including a full Equality Analysis of the proposals which addresses issues raised in this consultation in more detail, alongside advice and expertise from other sources.</p>

<ul style="list-style-type: none"> • Women take longer to use the toilet, which means they need more facilities to reduce queueing • Women who are vulnerable and/or have experienced trauma will be deterred from using them • Lack of privacy in a shared facility • Shared facilities are undignified, particularly in relation to periods, menopause and incontinence • Safety concerns including risk of assaults and sex crimes; risk of voyeurism and hidden cameras; risk to unaccompanied children; risk that someone with a health issue will not be seen or assisted promptly due to floor-to-ceiling doors on unisex cubicles • Opposition to concept of gender • Proposals contravene Part T of Building Regulations • Proposals contravene Supreme Court ruling on definition of a woman • Legal action will be taken against the Centre • Shared facilities with men are unhygienic • Unisex cubicles take longer to use and will exacerbate queueing • Some people need single sex facilities for religious reasons • People with learning disabilities may find it hard to understand which toilet to use • Older people do not like unisex toilets, older men need access to urinals, older women are more impacted by dirty toilets • Concern that only unisex facilities are being provided in future • Disagreement with co-design finding that non-gendered toilets are a priority 	
--	--

Toilets – other:

Summary of feedback	Project response
<p>Other comments and suggestions were made in relation to toilets, as follows:</p> <ul style="list-style-type: none"> • Refurbishment is badly needed due to the poor quality of existing facilities • Cubicle sizes should be larger and include basins for privacy and needs such as menstruation • Improvements are needed to baby changing facilities 	<p>The comments have been noted and our proposals include a significant increase in ‘universal’ cubicles with integrated handwashing facilities. There will also be more and improved baby changing facilities and more toilets throughout the building with an increase in the number that can be used by women.</p>

- | | |
|---|--|
| <ul style="list-style-type: none">• General support for an increase in the number of toilets, the need for more women's toilets and ensuring toilets are easily available throughout the building• Space could be taken from men's toilets if necessary as they do not have to queue currently | |
|---|--|

Foyers: consultation findings and updates

In relation to the Foyers, 92% of respondents agreed or strongly agreed with our proposals.

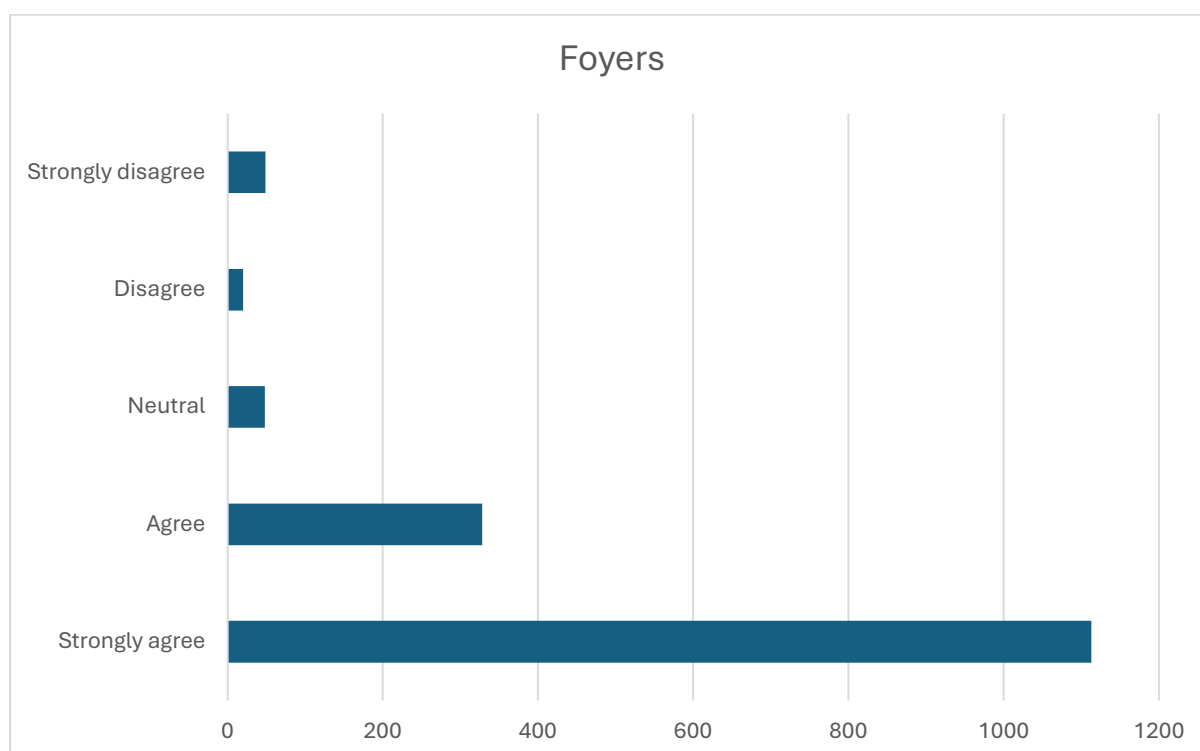

Figure 2: chart of responses to the Foyers project

As with the Renewal section, comments summarised below were made by very low numbers of respondents, each in single figures apart from one of the comments in relation to wayfinding which was made by 11 individuals. The comments are summarised below, with responses and updates from the project team, in alphabetical order by category of issue raised.

Accessibility:

Summary of feedback	Project response
<p>Comments in support of increasing the accessibility of the Foyers, including:</p> <ul style="list-style-type: none"> • Support for the proposal for a new lift • Suggestion to include escalators (with reference to Royal Opera House and other large buildings) 	<p>Design for all is one of our design principles for Renewal and accessibility for older and disabled people is a key part of achieving this. Renewal has already been informed by specialist support from Arup Inclusive Environments as well as engagement with disabled stakeholders and Centre users. An Access and Inclusion Advisory Group has been established to ensure that disabled people's expertise and lived experience remain central to the development of the project. More detail on plans is available as part of the planning application. This does not include escalators, which we do not believe are practicable within the historic design of the listed Barbican Centre.</p>

Architecture and heritage:

Summary of feedback	Project response
<ul style="list-style-type: none"> • A concern that the plans as set out change the Brutalist style of the Foyer • Suggestion to integrate the different levels of the Barbican and make it feel less disjointed • Suggestion to re-open the circle entrance to Theatre left via the Members Room • Suggesting removing the later addition of an internal bridge in the Foyer (between Silk Street entrance and the Lakeside) • Restoring the original diamond-shaped chandelier that hung over the staircase 	<p>Celebrating the heritage of the listed building is at the heart of the Renewal programme. As much as possible we are preserving and restoring original features, while making sympathetic upgrades where necessary to improve accessibility, reduce energy use, meet modern safety standards and improve visitor experience. The proposals are designed to enhance and show off the original Brutalist design.</p> <p>A key proposal to integrate the different levels is the addition of a lift within the main foyer that would connect Level G, the mezzanine below it and Level -1. At present the step-free route between these spaces is very disjointed and requires travel either via the shop or crossing the internal roadway at Level -1.</p> <p>In relation to the internal bridge and chandelier, we do have a long-term aspiration to return to the original Foyer design, however this is not part of the current phase of work and would require an alternative step-free route from Silk Street to be created alongside alternative step free entrance routes into the Centre.</p> <p>The Members' room is not in the scope of Phase 1 but is likely to be looked at in future phases of Renewal.</p>

Art and performance programming:

Summary of feedback	Project response
Suggestions for public sculptures and other artworks in the Foyers	As part of our plans for the Foyers we intend there to be a more consistent and reliable arts offering, which is likely to focus on visual arts at Level G and performances in the new dedicated space at Level -1.

Bars:

Summary of feedback	Project response
<p>There were several comments on the Foyer bars as follows:</p> <ul style="list-style-type: none"> • Request to retain the Martini bar as feeling dark, quiet and comfortable • Concern about noise from moving the Circle bar closer to the Concert Hall • Concern about circulation and separation from moving the Circle bar 	<p>The Martini Bar is proposed to remain in its current position on Level 1 with improvements to the bar itself and nearby seating. This is likely to remain the Centre's 'destination bar' and lighting and interior design will reflect this intention.</p> <p>We have changed the proposed design of the Circle bar slightly to address concerns about its operation and circulation around the bar</p>

<ul style="list-style-type: none"> • Suggestion for a 'destination bar' in the Foyers that is a more special space for events and occasions 	and Circle doors to the Hall. It will be designed with appropriate acoustic separation to ensure no interference with concerts in the Hall.
--	---

Box office:

Summary of feedback	Project response
<p>Concern about the location and design of the proposed welcome and information point, due to:</p> <ul style="list-style-type: none"> • Past experience that this location was too noisy and busy with people walking past • The circular design being difficult for staff and customers e.g. knowing where to queue, staff feeling vulnerable • A suggestion that front of house staff should be involved in the future design • Concern about removal of the box office • Concern about removal of the welcome desk at the Silk Street entrance 	<p>We have selected the location for the new welcome and information point to be visible and accessible from all the main routes in the Level G Foyer (from Silk Street, Lakeside or the catering block).</p> <p>The exact location is expected to be less busy than currently as it will no longer be the main thoroughfare to Lakeside as the entrance bay by the lift lobby is being replaced with fixed glazing.</p> <p>The design of the information point will be created in close consultation with staff as key users of the facility and we will take into account concerns and experience about circular facilities.</p> <p>The box office at Level -1 is proposed to be removed for several reasons including much wider use of e-ticketing, the box office being closed much of the time and it being in an inconvenient location. Box office functions will in future be available where audiences need them most.</p>

Catering:

Summary of feedback	Project response
<p>Suggestions for improvements to restaurants, including:</p> <ul style="list-style-type: none"> • A upscale/fine destination dining option • More use of British and local produce (food and drinks) • General improvement to dining spaces, food and service • Cheaper food options • More doors to open onto Lakeside from the ground floor café 	<p>The café and restaurants on Level G, 1 and 2 are proposed to remain as catering outlets following a full refurbishment and refit. The detail of what catering is provided will come later in the programme and will be subject to a public procurement exercise to identify the most suitable partners to run the facilities.</p> <p>We do not propose to create more doors from the Lakeside café. We believe there are sufficient exits already and that the long glazed frontage is a popular and useful place for customers to sit. We are also working within the constraints of a listed heritage building.</p>

Doors:

Summary of feedback	Project response
---------------------	------------------

<p>Two comments expressed opposing views on changing the doors to the Lakeside:</p> <ul style="list-style-type: none"> • A respondent expressed support for the new doors as the current ones are difficult to use and unattractive • An alternative view expressed a preference for the existing doors due to them being quieter, historical and creating pause/drama at the entrance 	<p>The proposed design for the doors is intended to make them accessible for all users and to re-establish the historic link between the Foyers and Lakeside, which has been diminished by the later addition of a double layer of heavy, narrow doors.</p>
--	---

Flooring:

Summary of feedback	Project response
<p>A comment in support of the wooden floors at Level -1 (Hall stalls level)</p>	<p>The wood block flooring at Level -1 is a key feature of the original design which will be preserved along with other materials like the tiles, brass handrails and door furniture, terrazzo and hand-hammered concrete.</p>

General oppose:

Summary of feedback	Project response
<p>Two comments opposed the Foyers plan due to not being ambitious enough in proposing changes. Both responses suggested the Foyers are unwelcoming and dark and that the proposals would not address this.</p>	<p>These comments should be seen in the context of wide support for the proposals. Our proposals to restore the original lighting design and to bring in more natural light through the single line of doors will significantly enhance the foyers and enable us to flexibly zone spaces according to need and function.</p>

General support:

Summary of feedback	Project response
<p>A small number of comments offered general support for the changes, with some specific points made in support of:</p> <ul style="list-style-type: none"> • Making the doors more accessible • Having the box office facility at Ground level • Increasing seating • Improving lighting • Performance area at Level -1 • New floor coverings 	<p>The support is noted.</p>

Inclusion:

Summary of feedback	Project response
<p>Support for the co-design priority of including low-stimulation zones and sensory clues for neurodivergent people</p>	<p>A dedicated quiet room has been designed as part of the proposals. Further detailed design to ensure the Centre is welcoming for all will be created with input from our Access and Inclusive Design Advisory Group and</p>

	based on expert input from Arup Inclusive Environments.
--	---

Lighting:

Summary of feedback	Project response
A mix of comments in relation to lighting, including support for improvements to the lighting (specifically mentioning glare in the Silk Street entrance) as well as concern that if it becomes too bright or the lighting is of poor quality it will negatively impact the atmosphere of the space and the transition into the darkness of the venues.	Lighting designers have recreated the original light fittings using a low energy LED system. We intend to return high quality lighting to each of the square 'coffers' in the ceiling of the Foyers which will create brighter spaces overall but also allow us to zone areas for different uses through adjustable brightness and set moods for different needs, spaces and times of day.

Performance:

Summary of feedback	Project response
<ul style="list-style-type: none"> A concern about removing the Level G 'Free Stage' due to the successes of the current location (popular, good audiences, balcony views from above, promotes other events, provides custom for hospitality outlets, preserves access to the Hall) A concern raised that the new location for the performance space on -1 would be difficult to find and people would not happen across it spontaneously. A suggestion that the Centre needs a smaller 'studio'-style performance space and that the -1 performance space should be more permanent than temporary. 	<p>While the Level G Free Stage has been popular and well used for many years, it has a number of challenges for audiences, performers and Centre staff. The sight lines are very restricted, it blocks one of the main sets of doors to the Lakeside and needs of different audiences and customers can be in conflict (e.g. people socialising in the Foyer/using the café vs people watching the performance. A dedicated space at Level -1 will allow us to provide a better experience for all while mitigating the risk of sound escaping and disturbing our residential neighbours. We believe that more people will be able to enjoy the new space, which will still be easily accessible from the main Level G Foyer.</p> <p>There are no plans currently to create an additional studio but we will continue to activate different parts of the Centre for art and performance outside the main venues.</p>

Seating and furniture:

Summary of feedback	Project response
<p>A variety of comments in relation to seating and furniture, including:</p> <ul style="list-style-type: none"> Suggestion for more and better seating in the Foyers Support for the original Robin Day seating design Concern that the CGI images in the consultation suggest the furniture is being removed 	<p>The Renewal programme will include significant improvements to furniture, with more places to sit and better and more flexible furniture for a range of needs and uses. The design of this will be developed at a later stage of the project and is not subject to planning permission, so no further details are available currently. We are however looking at zoning the spaces with the heart of the</p>

<ul style="list-style-type: none"> • Comment that furniture needs to accommodate people during the day for a range of uses such as reading, working and meeting friends 	Foyers kept flexible for different uses and work/study areas provided separately to more social spaces.
--	---

Shop:

Summary of feedback	Project response
<p>A small number of comments raised concerns about the proposed new location of the shop:</p> <ul style="list-style-type: none"> • Concern about the new location of the shop being less visible than currently • Concern about the new location of the shop being less commercially viable than currently • Support for the existing location of the shop creating buzz at the entrance to the Centre 	<p>The Renewal of the Foyers aims to bring more people into the heart of the space, including by reinstating the central bays as the main connection with Lakeside, creation of a new block of toilets and other facilities, the location of a new welcome and information desk and the location of the new shop. The shop will have good visibility within the space and the footprint is more suitable to what is needed than the current shop.</p> <p>More detail about the case for removing the current shop and how this reinstates original views across the space is available as part of the planning application.</p>

Wayfinding:

Summary of feedback	Project response
<ul style="list-style-type: none"> • General support for improvements to signage and wayfinding (including comments about the difficulty of navigating the Centre currently). • Concern about wayfinding improvements and that they might lessen the maze-like aspect of the Barbican's character and the connection people feel with the venue as they get to know their way around 	<p>Improvements to wayfinding and signage will be a major part of Renewal, however design proposals are not yet developed so do not form part of this consultation. We are currently (May 2025) appointing consultants to work on this with us and all feedback will be shared with them as they start their work, which will be subject to future public engagement and applications for consent.</p>

Workspace:

Summary of feedback	Project response
<p>Comments reflecting different views on the use of the Centre Foyers for study or work, including:</p> <ul style="list-style-type: none"> • A concern that people working dominate the Foyer seating without participating in the life of the Centre. This included suggestions that computer users should have a dedicated area with an hourly charge and not be allowed to take up seats in the evening before performances • A desire to keep or rearrange the study spaces so that people can continue to work flexibly 	<p>The Centre will continue to welcome people who work and/or study as part of their visit. We are however looking at zoning the spaces with the heart of the Foyers kept flexible for different uses and work/study areas provided separately to more social spaces.</p>

Lakeside: consultation findings and updates

In relation to the Lakeside, 95% of respondents agreed or strongly agreed with our proposals.

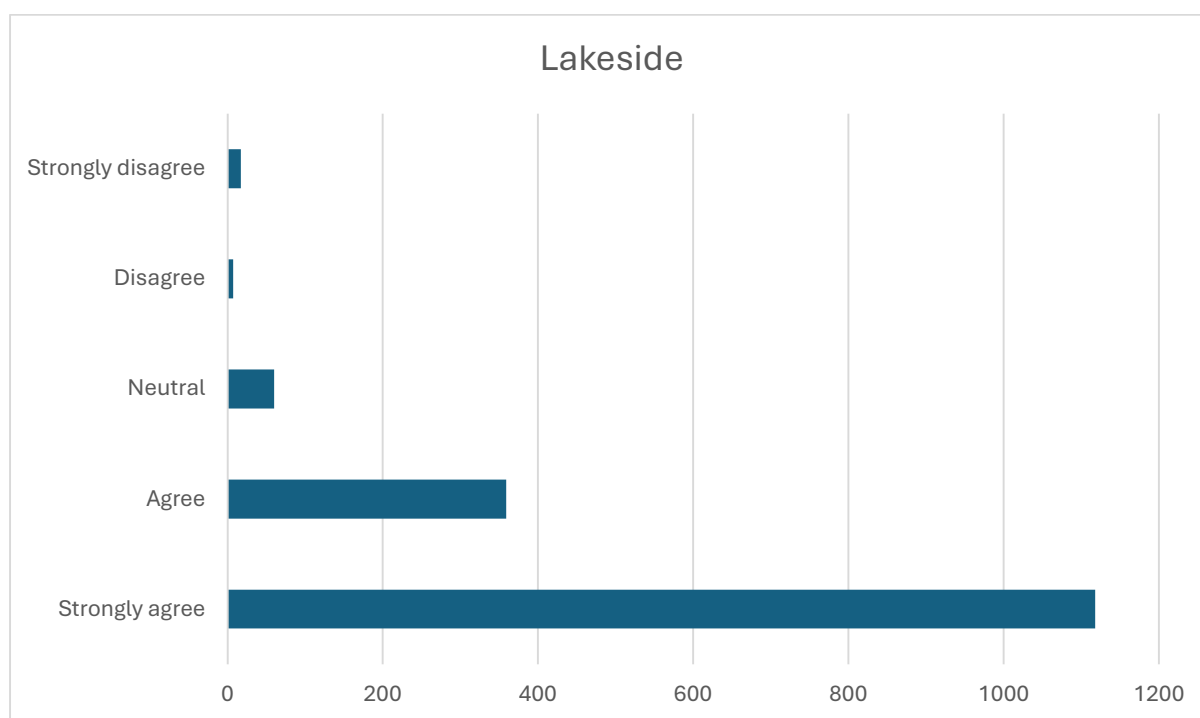

Figure 3: chart of responses to the Lakeside project

As with the Renewal overall and Foyers categories, the issues summarised and responded to below were made by very small numbers of respondents, each in single figures.

Accessibility:

Summary of feedback	Project response
Concern that the staircase from Lakeside to Podium is in poor repair with water pooling that makes it difficult to use the handrails.	This staircase will be fully refurbished as part of the Renewal of Lakeside.

General support:

Summary of feedback	Project response
Comments offered general support for the Lakeside proposals including mentions of restoring the fountains, providing shading and increasing sustainability.	The support is noted.

Heritage:

Summary of feedback	Project response
Two responses made mention of the Lakeside heritage, one urging the use of materials that match the originals and the other concerned that the proposals are cluttered and obscure the Brutalist	The proposals for Lakeside are first and foremost a restoration of the original design, which includes removing later additions and clutter such as flagpoles and the large, black monolith sign. Any new materials will match the look and quality of the originals as closely

architecture (although without specifying which elements this referred to).	as possible, with some subtle changes such as an upgrade to the glazed elements of the façade. The only significant visual changes proposed are the addition of awnings to shade the catering block which will be sensitively designed to minimise their visual impact while providing essential shade on this south-facing side of the building. More detail of the designs is available as part of the planning application.
---	--

Impact on residents:

Summary of feedback	Project response
A concern was raised that increased lighting and visitor numbers would affect neighbouring Barbican residents.	<p>We are very conscious of being good neighbours and carefully balancing the operations and artistic programming of the Centre with the need to avoid undue noise and disturbance and prevent public nuisance.</p> <p>We will continue to work closely with residents' representatives (particularly the House groups, Barbican Association, Neighbourhood Forum and ward councillors) throughout the development of Renewal, including updating our Visitor Management Plan in consultation with residents to manage any impact on the local community. Lakeside lighting will be sensitively designed, recreating or taking inspiration from original fittings while reducing light pollution and ensuring light is directed downwards. We will focus on lighting key routes and edges of the Barbican Centre building to help with visitor egress and highlighting the lake while leaving other areas in darkness.</p>

Members:

Summary of feedback	Project response
A suggestion was made that there should be a Members' area on the Lakeside.	We do not propose to create a Members' area on Lakeside and will be maintaining it as a public space.

Other developments:

Summary of feedback	Project response
A comment was made that the CGI of the Lakeside should show the proposed 1 Silk Street development and that this would negatively impact the existing view.	1 Silk Street is a proposed development external to the Barbican Centre, which is still subject to the planning process. As such it would not be appropriate to include it in our drawings, which were designed to show the future look of the Lakeside terrace itself

	rather than any potential changes to the skyline around it.
--	---

Planting and wildlife:

Summary of feedback	Project response
<p>A suggestion that planting can add shade and ambience to the Lakeside.</p> <p>A comment that the Lake has partly rewilded and is home to nesting birds, with a request that this is allowed to continue.</p>	<p>Planting designs for the external areas are being developed with the intention to increase the amount of planting at both lake and balcony level and for the design to be in keeping with the eco-Brutalism of the Conservatory. Planting will be designed to support biodiversity and the wildlife of the Estate.</p>

Seating and furniture:

Summary of feedback	Project response
<ul style="list-style-type: none"> A suggestion that there should be plenty of casual seating and lounging areas for the community to enjoy. A separate comment that colour and style of seating need to be cohesive with the rest of the Lakeside style 	<p>As with the Foyers, the Renewal programme for Lakeside will include significant improvements to seating, with more places to sit and better and more flexible furniture for a range of needs and uses. The detailed design of this is for a later stage of the project, so no further details are available currently.</p>

Shading:

Summary of feedback	Project response
<p>A range of comments in relation to shading covering the following specific points:</p> <ul style="list-style-type: none"> Support for more outdoor covered space due to the direct sunlight on the Terrace Support for shade for the restaurant areas Concern that the awnings proposed are not large enough to shade the current outdoor seating from the southern sunshine Concern that the design of the awnings is not in keeping with the facade and that umbrellas would be preferable 	<p>The comments in relation to existing plans for shading have been noted and we will also consider them in future work on the seating areas. We believe that the designs of the awnings strike an appropriate balance between the need to shade both the outdoor seating areas and the glazed south-facing facades of the catering block, while celebrating the iconic listed design of the Lakeside terrace.</p>

Water features:

Summary of feedback	Project response
<p>Concern that the 'aerator' fountains contained within the Lake are not shown in the images and a request that they are included in Renewal.</p>	<p>The aerator fountains will be renovated as part of Barbican Renewal along with the Lakeside terrace fountains and the waterfall, all of which will benefit from a new control and pumping system.</p>

Windowsill:

Summary of feedback	Project response
Comment that it is difficult to see the design of the lowered windowsill from the images provided.	The feedback is noted and more detailed images are available as part of the statutory consultation on the planning application in summer-autumn 2025.

Conservatory: consultation findings and updates

In relation to the Conservatory, 93% of respondents agreed or strongly agreed with our proposals.

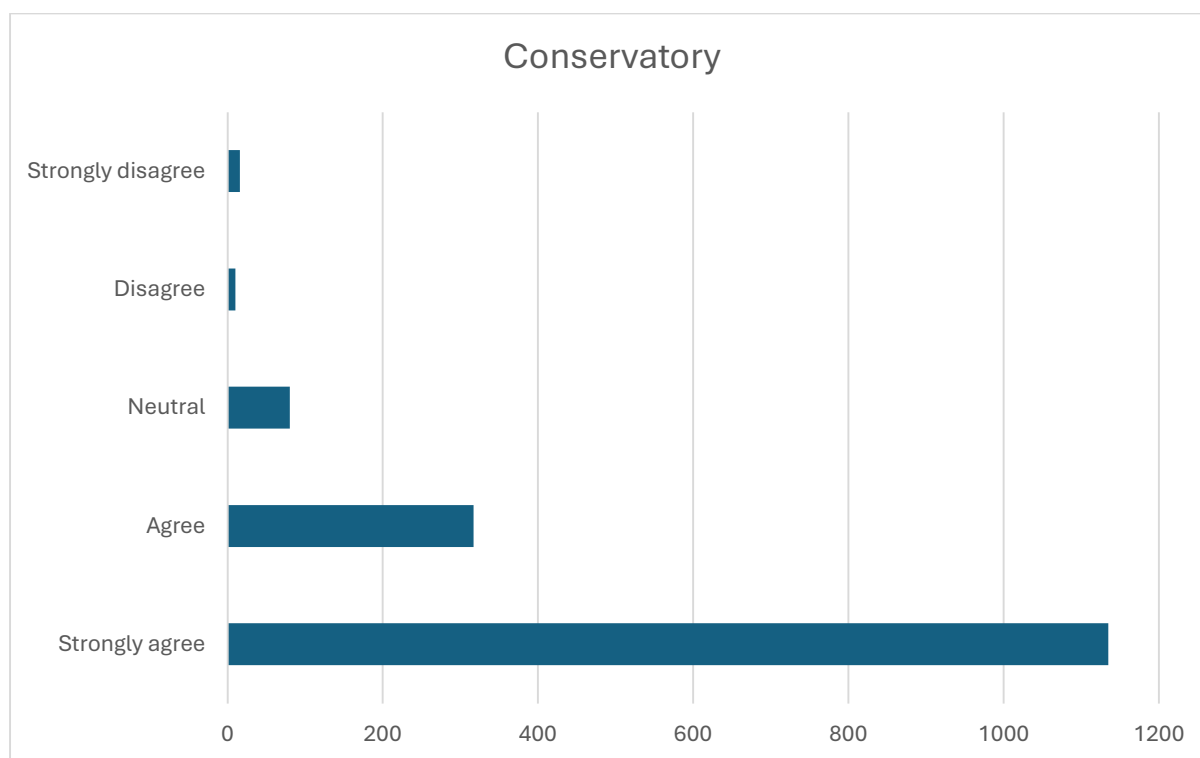

Figure 4: chart of responses to the Conservatory project

As with the Renewal overall, Foyers and Lakeside categories, the issues summarised and responded to below were made by very small numbers of respondents, each in single figures.

Budget and funding:

Summary of feedback	Project response
<ul style="list-style-type: none"> Concern that capital investment in the Conservatory will be at the expense of other parts of the Centre requiring Renewal Concern about the ongoing revenue cost to sustain the facility 	<p>The Conservatory is one of the parts of the Centre most urgently needing Renewal as the fabric of the structure is failing, particularly the glazing and the waterproofing. Failing to address these would likely require the closure of the Conservatory within the near future and water ingress in particular has a damaging impact on the Theatre which sits below the Conservatory. The budget for Renewal has been calculated to address all the most important works for Phase 1 including completing these to the high quality of design and finish that visitors and audiences expect from the Centre. Further budget will be needed for later phases of Renewal. While there is of course revenue cost of maintaining the Centre's facilities, the</p>

	Conservatory is a commercial asset and Renewal will provide better event hire spaces enabling an increase in commercial income to help fund the public areas of the Centre.
--	---

Catering:

Summary of feedback	Project response
Suggestion to include a permanent café facility as part of the Conservatory	Our proposals do not include a permanent café within the Conservatory, however we are designing a flexible catering space as part of the Garden Room and there will be possibilities to provide pop-up catering as required.

Entrances:

Summary of feedback	Project response
Suggestion to improve and make clearer the entrance to the Conservatory	Our proposals are for the original entrance to the Conservatory (from the Sculpture Court) to become the new 'main' entrance, with a new welcome and arrival area just inside. Designs for this are available to view as part of the planning application.

Events:

Summary of feedback	Project response
<ul style="list-style-type: none"> • Opposition to hosting private events that might damage the plants • Concern from a nearby resident about an increase in private functions and potential for noise and light pollution affecting the Barbican Estate 	<p>The new designs for the Conservatory are intended to create more separation between the private event spaces (Garden Room and Terrace) and the main Conservatory, to enable much greater public access throughout the week. That said, there will still in future be events across the whole Conservatory as there have been for decades and our venue managers and gardening team will ensure that these are held in a way that ensures the plants are nurtured and respected.</p> <p>We have prepared a Venue Management Plan for the space to make sure it is effectively managed. We will consult on this plan as the project develops in advance of the renewed Conservatory opening in 2030.</p> <p>The event spaces will continue to be used as they are now to host private events, with design improvements significantly reducing noise spill outside due to the new glazed containment. Lighting is being designed to improve performance and minimise pollution, lighting the interiors sensitively without disturbing neighbours.</p>

Glazing of terrace:

Summary of feedback	Project response
Two responses required clarification about the glazing-in of the Conservatory Terrace. The first highlighted a confusion about where this space is located, suggesting that it was an exterior space that would be newly glazed for commercial purposes. The other wanted to check that the new, glazed structure would be a similar form with improved glazing specification.	The Terrace is a space within the main Conservatory at the upper level, it is not an external terrace. It is mainly used as an event space for private hire, and currently this restricts the possibility of publicly opening the Conservatory at the same time. Our proposal is to create a glazed wall, designed to be in keeping with the rest of the Conservatory construction, to separate the terrace from the rest of the Conservatory which will allow us to hold private events while still maintaining public access. It will also contribute to our sustainability goals because the enclosed Terrace will be conditioned for human comfort whereas the main Conservatory will be passively heated and cooled to be appropriate for the plants at different times of year.

Other:

Summary of feedback	Project response
Suggestion that the Conservatory isn't needed and could be put to better use.	This comment should be seen in the context of the popularity of the Conservatory and very high level of support for Renewal proposals. The Conservatory is part of the listed Barbican Estate and is a treasured hidden gem which Renewal intends to make available to a much wider public.

Outside Centre:

Summary of feedback	Project response
Concern about impact of scale of proposed 1 Silk Street development on viability of plants in the Conservatory	We are closely following the development of the 1 Silk Street proposal and do not believe that the current plans will affect light in the Conservatory to the extent that plants would be negatively impacted.

Plants:

Summary of feedback	Project response
Support for the planting proposals and creation of a nursey	The feedback is noted.

Public access:

Summary of feedback	Project response
Support for increasing public access to the Conservatory, including suggestions for gardening events, sales of cuttings and	The support is noted and plans for 'activation' of the Conservatory will be developed ahead

enthusiasm for being able to access the balconies	of its re-opening in 2030 (subject to planning permission).
---	---

Staircase:

Summary of feedback	Project response
A small number of comments on the design of the new staircase, including it needing more work 'on aesthetic grounds'; concern about the size and visual impact; concern about it being out of keeping with the architectural heritage; and support for the materials chosen.	The feedback is noted but should be seen in the context of strong support for the plans and designs presented in the consultation. The staircase has been designed to be a new feature of the space and more details of the proposal are available as part of the planning application, subject to consultation in summer-autumn 2025.

Water features:

Summary of feedback	Project response
A request for more information as to why the pond is unsuitable for the koi carp and a request to keep some fish in the future Conservatory.	The carp have outgrown their current location and need a greater size and depth of pool that can be accommodated in the Conservatory. They will be rehomed into a more suitable environment. We do not plan to have fish or reptiles in the Conservatory post-Renewal and will focus on it being a showcase for a wide variety of plants.

Wayfinding:

Summary of feedback	Project response
A suggestion for better signage to find the Conservatory from the ground floor	This will form part of the wayfinding project which is part of Phase 1 of Renewal but not the subject of the current consultation or planning application as details are yet to be developed.

Next steps

This report forms part of the Statement of Community Involvement being submitted in July 2025 in support of the Barbican Centre's application for planning permission for Phase 1 of Renewal. The report demonstrates overall a very high level of support for the Renewal proposals, alongside a number of comments and queries on specific topics, which have been addressed above.

It is clear that, unlike the earlier January-February consultation, the main topic of interest in this consultation became the Renewal proposals for changes to toilets facilities across the areas in scope of Phase 1. The details of the proposed changes along with a rationale for these and a full Equality Analysis has been provided as part of the planning application. This application will be subject to a further statutory public consultation run by the City of London Corporation, expected in summer-autumn 2025 ahead of planning decisions.

Subject to planning permission and listed building consent for the projects, we intend to begin construction in 2027 with completion by 2030.

Appendix: consultation publicity

The consultation was widely promoted to local residents, stakeholders and Centre audiences.

Digital channels included emails to key contacts, e-newsletters from the Barbican Centre to its audience mailing lists and e-newsletters from the City of London.

Offline promotion included a letter-drop to over 7,000 residents and businesses around the Barbican Centre, including the Barbican Estate, Golden Lane, Little Britain and communities in south Islington. Examples of publicity are included below.

Barbican Estate residents

Barbican Estate bulletin, printed letters

To inform residents of the consultation, content was included in the Barbican Estate's weekly bulletin over three weeks, from Friday 16 May to Friday 30 May.

Barbican Renewal Public Consultation: 19 May - 2 June

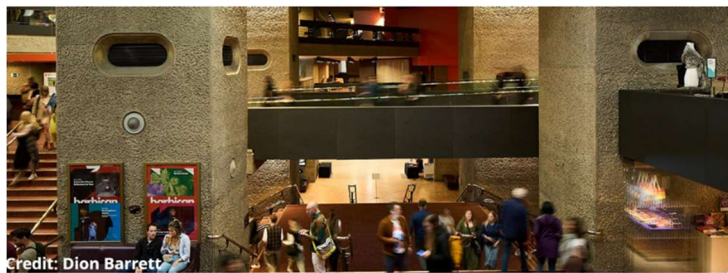

Following consultation earlier this year, Barbican Renewal is back with updated plans for the Centre's Foyers, Lakeside and Conservatory and they're inviting residents to have your say.

See new images of the design proposals for the Centre and comment online on the [Barbican Renewal website](#).

Get involved online or in-person by attending a webinar from 2-3pm on Monday 19 May (see website for details) or attend a drop-in event to chat and ask questions to project experts:

- 5.30pm to 7.30pm, Thurs 22 May, Frobisher Rooms 4 and 5 (Level 4)
- 6.30pm to 8.30pm, Fri 23 May, Garden Room (Level 3)
- 12.30pm to 3pm, Thurs 29 May, Fountain Room (Level G)
- 12.30pm to 3pm, Fri 30 May, Fountain Room (Level G)

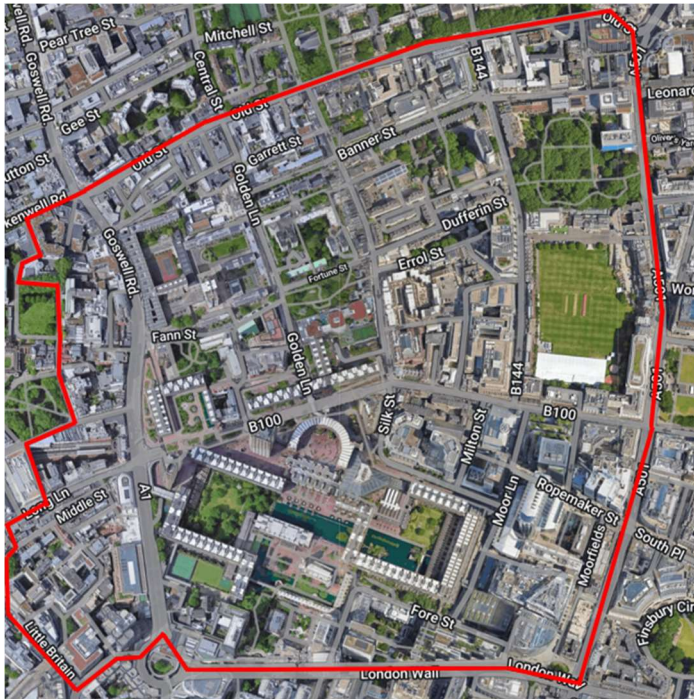

Residents also received a printed letter, hand-delivered by the Barbican Estate Office. This featured the webinar informing the public of the consultation proposals (which took place on Monday 19 May).

Barbican Centre
Silk Street
London EC2Y 8DS
+44(0)20 7638 4141
barbican.org.uk

Dear neighbour,

Barbican Renewal public consultation 19 May – 2 June

Following a consultation in January and February, we invite you to take part in the next phase of public consultation for Barbican Renewal, ensuring the Barbican Centre is restored, revitalised and relevant for future generations.

This next consultation will explain how the Renewal team has responded to feedback received from the first consultation and how our designs have progressed as a result. The focus will continue to be on Phase 1 of Renewal, running from 2025-2030, and in particular our plans for the Lakeside, Foyers and Conservatory.

There are several ways to get involved:

- Online at barbican.org.uk/renewal
- Attend a webinar on Monday 19 May, 2pm (see website for details)
- Attend a drop-in event at the Centre:
 - Thu 22 May, 5.30-7.30pm, Frobisher Rooms 4 and 5
 - Fri 23 May, 6.30-8.30pm, Garden Room
 - Thu 29 May, 12.30-3pm, Fountain Room
 - Fri 30 May, 12.30-3pm, Fountain Room

You can also email us at barbicanrenewal@barbican.org.uk or write to us 'FAO Barbican Renewal' at the address at the top of this letter.

Yours faithfully

Philippa Simpson
Director for Buildings and Renewal



barbican

Wider local audience – communities

Leaflets, posters

Around 9,000 leaflets were distributed to local organisations by Culture Calling. These included community spaces in Farringdon and the City, as well as community centres in Shoreditch and Hoxton. 50 posters were placed in shopfronts and windows of local businesses in the City and Farringdon.

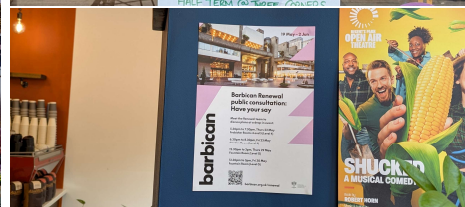
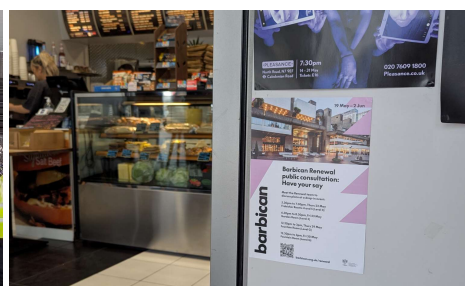

General audience – Centre audiences and wider public

Newsletters, emails

To target the Centre’s national audience, the consultation was advertised on the Barbican Centre’s LinkedIn platform.

Several newsletters were sent to different segmented audiences. A solus (dedicated) newsletter was distributed to on Monday 19 May. Separately, shortform content was included in both the Barbican’s cross-arts weekly Thursday newsletter, as well as the Members’ Wednesday newsletter.

Barbican Centre
89,802 followers
4w • Edited •

Barbican Renewal is entering an exciting new chapter with fresh designs unveiled and strong public support 🌟

Today, we are thrilled to share our bold vision for the future as the second stage of the public consultation for our historic Renewal programme begins 🌟

Newly released images offer a first look at how the Barbican’s Conservatory, Lakeside and Foyers might look in the future following the first phase of a once-in-a-generation transformation of the world-renowned cultural landmark 🌟

Following an overwhelmingly positive response to the first consultation – with around 90% of respondents expressing support – the designs have been refined to reflect the feedback received.

Now we want to hear from you again! 🌟

Join our webinar at 2pm today (19 May):
<https://lnkd.in/d3ivvZ-e>

Attend a drop-in session at the Barbican Centre:
<https://lnkd.in/d3Ectb5t>

View the new designs and share feedback online (19 May – 2 June):
<https://lnkd.in/d3Ectb5t>

A Grade II-listed architectural icon and one of the UK’s top 20 cultural attractions, the Barbican Centre attracted 1.54 million visitors last year alone. After 40 years of activity, the time has come for a much-needed upgrade 🌟



Supported by a £191 million commitment from the [City of London Corporation](#), representing 80% of the funding needed for phase one, this is just the beginning! Construction is set for 2027, with this phase due for completion in 2030, just ahead of the Barbican’s 50th anniversary in 2032 🌟

The world-class team delivering the programme is led by architects [Allies and Morrison](#) working with [Asif Khan Ltd.](#) and engineers [Buro Happold](#), [les éclaireurs](#) - lighting designers, inclusive design advisors [Arup](#), circular economy experts [Reusefully Ltd.](#) and landscape designers [Harris Bugg Studio](#) 🌟

Kin Creatives for Allies and Morrison and Asif Khan Studio

[#BarbicanRenewal](#) [#Barbican](#) [#DesignForTheFuture](#) [#LondonCulture](#) [#Architecture](#) [#Sustainability](#)



barbican  

New on sale Read, Watch, Listen What's On Shop Membership

Hello,

Following a public consultation earlier this year, we are now able to share updated plans for Barbican Renewal, looking at the Centre's Foyers, Lakeside and Conservatory – and we invite you to have your say.

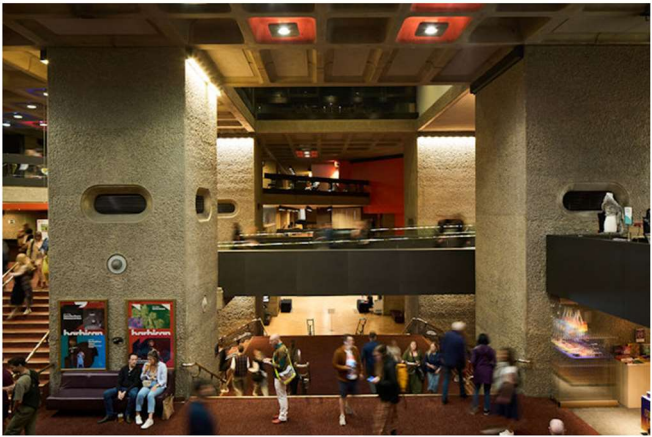

With new details and exciting visuals, proposals have been shaped by public feedback.

This consultation is now open until Mon 2 June.

[Have your say](#)