

Frobisher Rooms Level 4

Barbican Centre
Silk Street
London EC2Y 8DS
Tel +44 (0) 7382 7043
business.events@barbican.org.uk
www.barbican.org.uk

Facilities

- free delegate wi-fi
- toilet facilities including accessible WC
- lounge seating
- standard 13 amp power (other power to quote)
- USB charging points in public areas

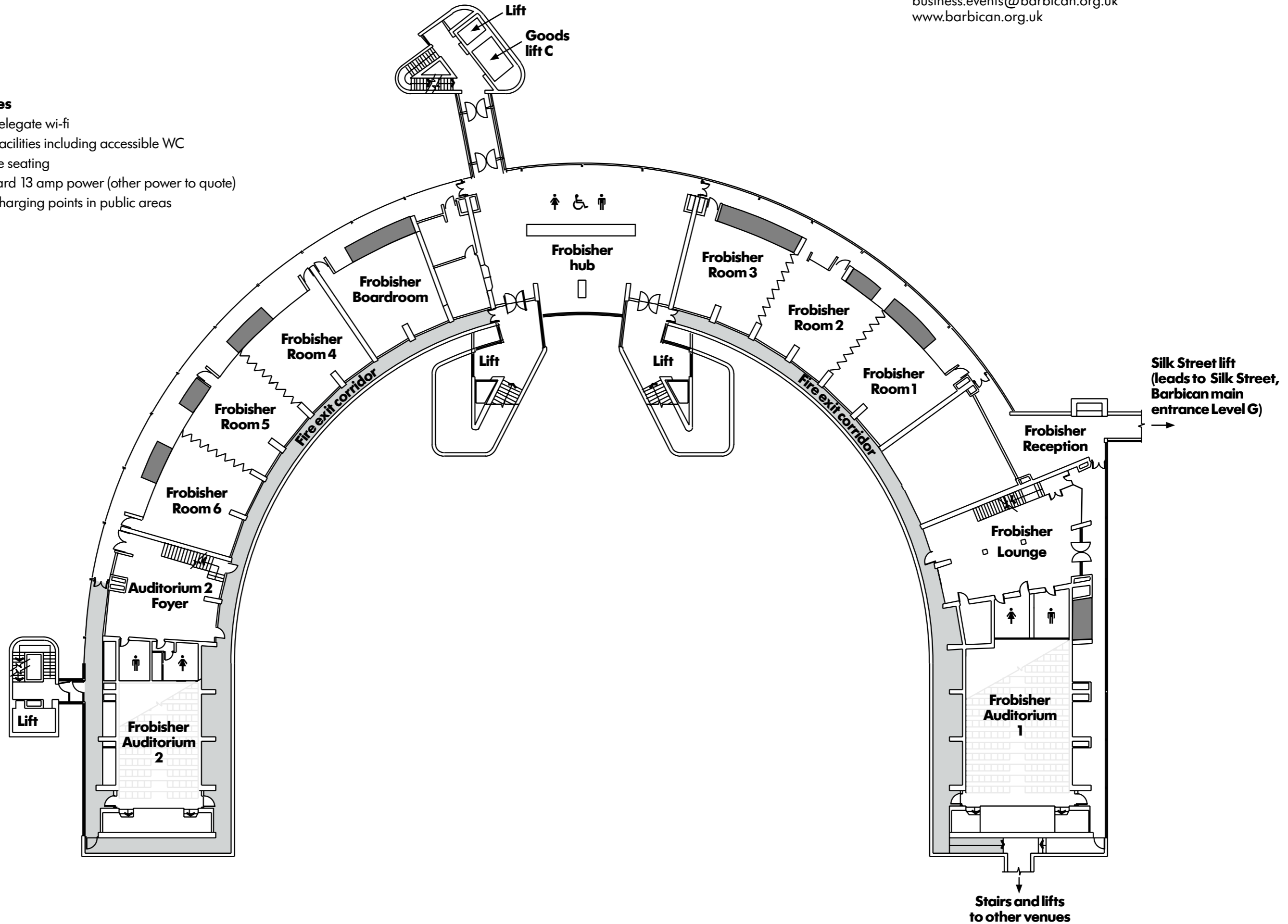

Frobisher Auditorium 1 Level 4

Capacity

total 243 plus 3 wheelchair position
or 232 plus 6 wheelchair positions

Auditorium dimensions

width 8.55m
length 20.95m

Stage dimensions

area 12.2m² (131 sq.ft.)
width 7.3m (22'2")
length 1.6m (5'6")
height MAX 4m (13'1")

Facilities

- free delegate wi-fi
- perlux screen 5.3 x 2.9m (17'4" x 9'5" with variable masking)
- projection facilities
- dedicated technician
- integrated sound system
- coloured stage and wall lighting
- comfort cooling
- adjacent to Frobisher Lounge
- accessible via passenger lifts, stairs and goods lift
- standard 13 amp power (other power to quote)

Plan to be used as guide only

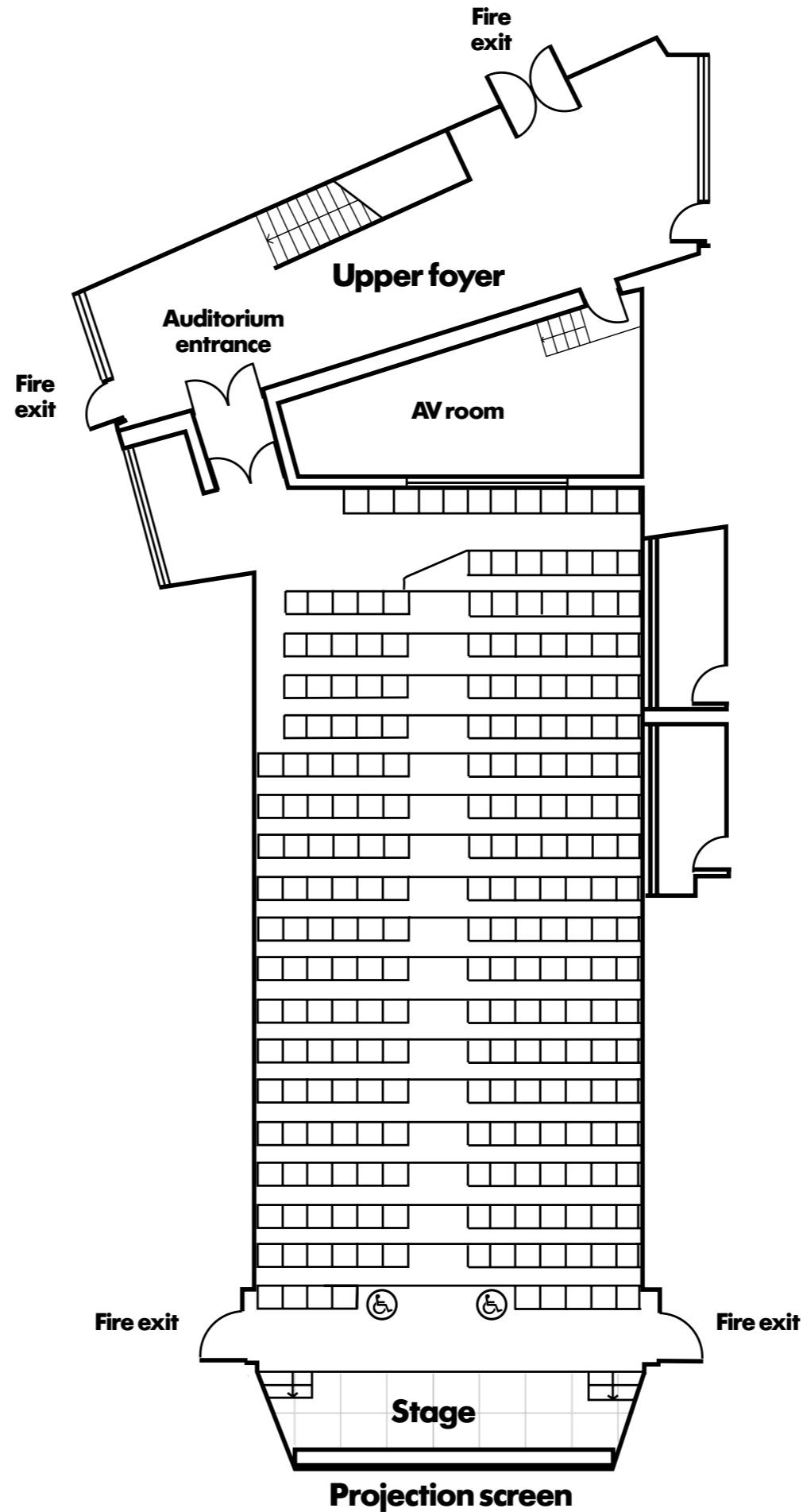

Barbican Centre
Silk Street
London EC2Y 8DS
Tel +44 (0) 7382 7043
business.events@barbican.org.uk
www.barbican.org.uk

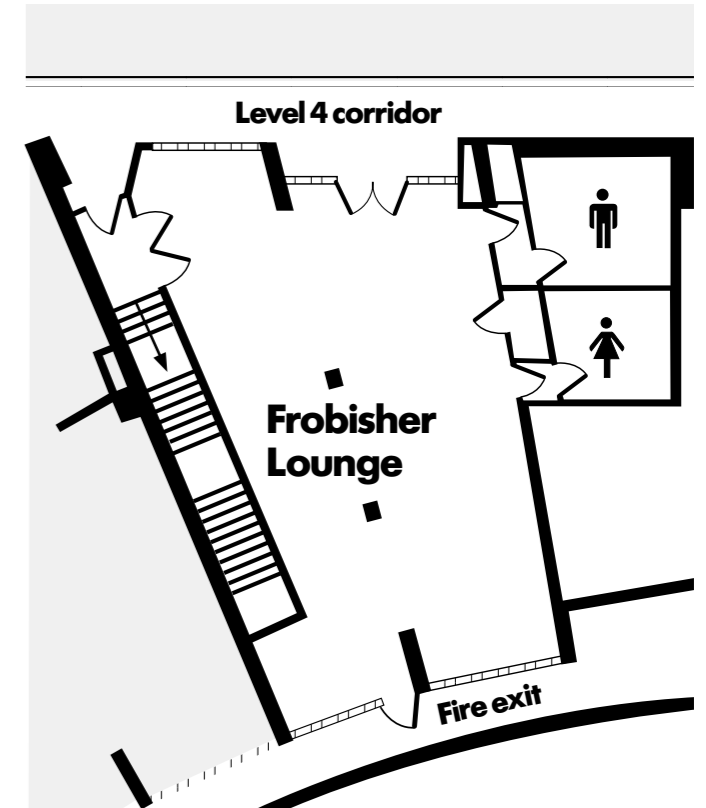

Frobisher Auditorium 2 Level 4

Capacity

total 151 plus 2 wheelchair positions

Auditorium dimensions

width 6.5m

length 17m

Stage dimensions

area 8.9m² (96 sq.ft.)

width 5.3m (17'7")

length 1.6m (5'6")

height max 4m (13'1")

Facilities

- free delegate wi-fi
- perlux cinema screen 4.7 x 2.6m (15'4" x 8'5" with variable masking)
- projection facilities
- dedicated technician
- integrated sound system
- coloured stage and wall lighting
- induction loop
- comfort cooling
- private foyer area
- accessible via passenger lifts, stairs and goods lift
- standard 13 amp power (other power to quote)

Plan to be used as a guide only.

Each grid square represents 1m²

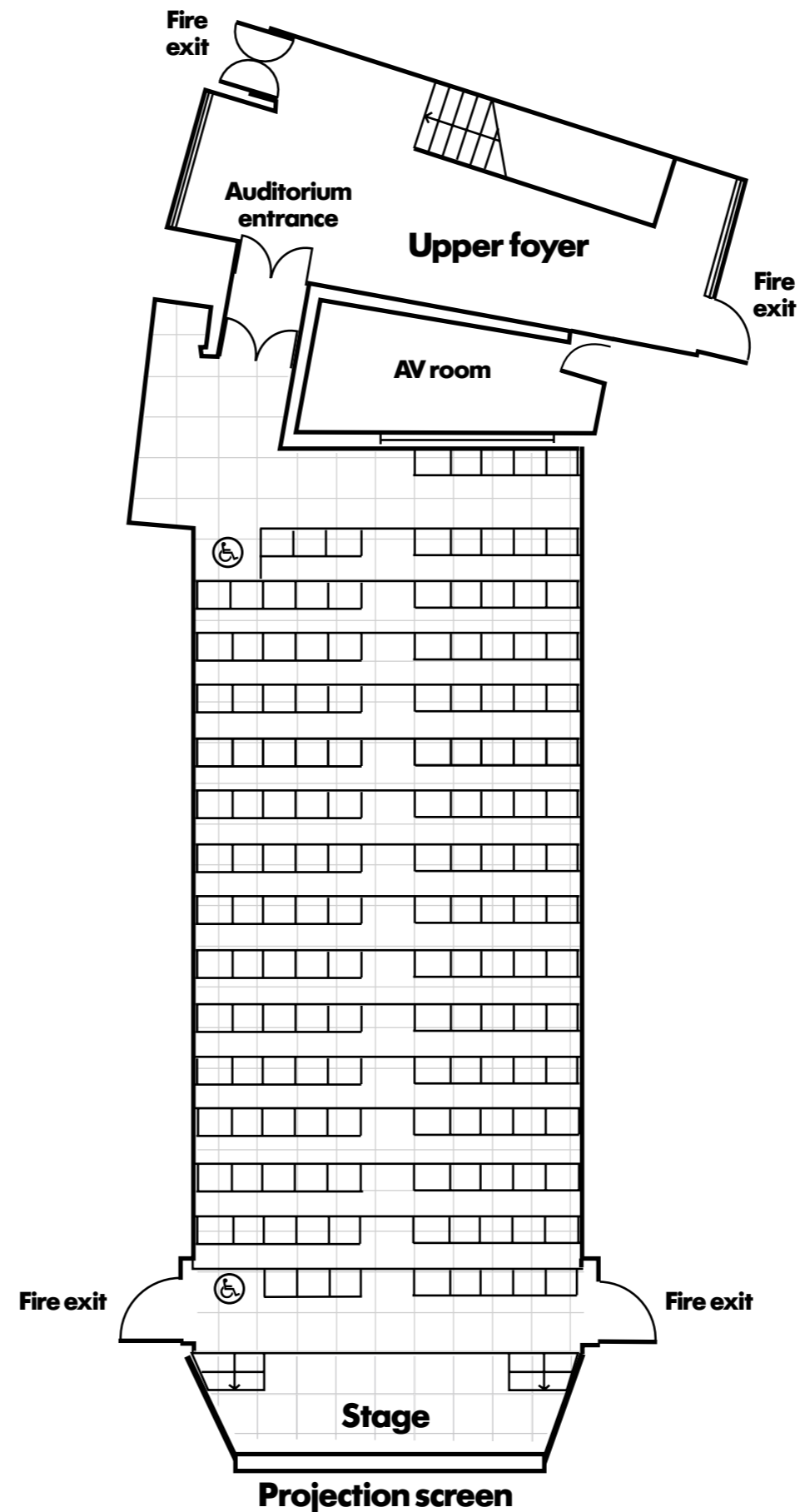

Barbican Centre
Silk Street
London EC2Y 8DS
Tel +44 (0) 7382 7043
business.events@barbican.org.uk
www.barbican.org.uk

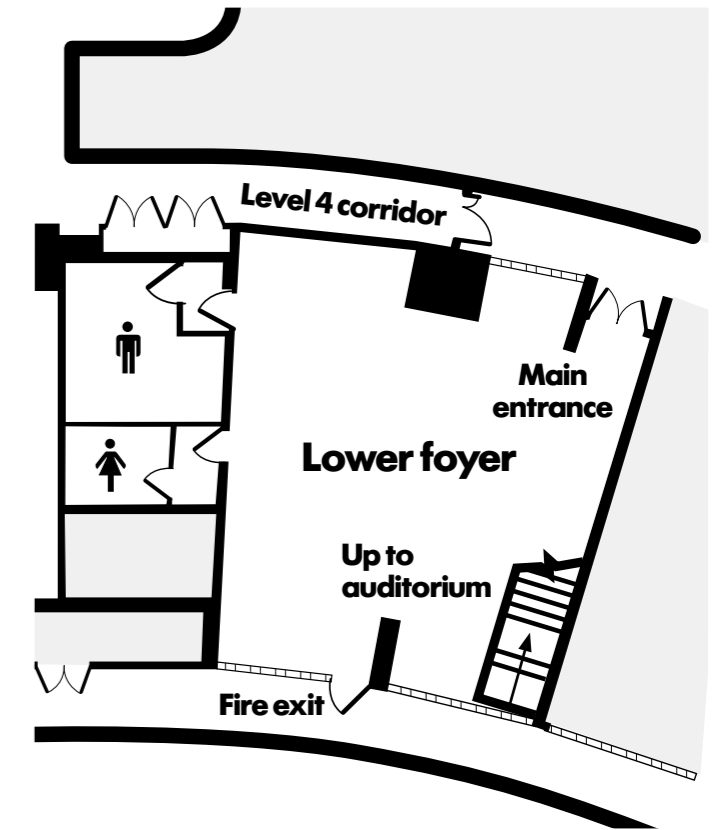

Frobisher Room Single Room Level 4

Barbican Centre
Silk Street
London EC2Y 8DS
Tel +44 (0) 7382 7043
business.events@barbican.org.uk
www.barbican.org.uk

Capacity

| | |
|-----------------|--------|
| theatre style | 50 max |
| classroom style | 24 max |
| u-shape style | 20 max |
| boardroom style | 16 max |

Dimensions

| | |
|--------|-------------------------------|
| area | 72m ² (775 sq.ft.) |
| width | 8m (26'3") |
| length | 9m (29'6") |
| height | 4m (13'2") |

floor loading 100lbs/sq.ft.

Venue facilities

- free delegate wi-fi
- flown projector and screen 4x3m (13'x 9'8")
- natural daylight, blackout blinds, dimmable lighting and comfort cooling
- directional signage
- accessible via passenger lifts, stairs and goods lift
- frobisher rooms are all wheelchair accessible
- Standard 13 amp power (other power to quote)

Plan to be used as a guide only.
each grid square represents 1m² (approx).

Main entrance and fire exit

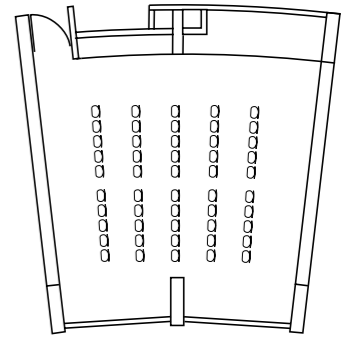
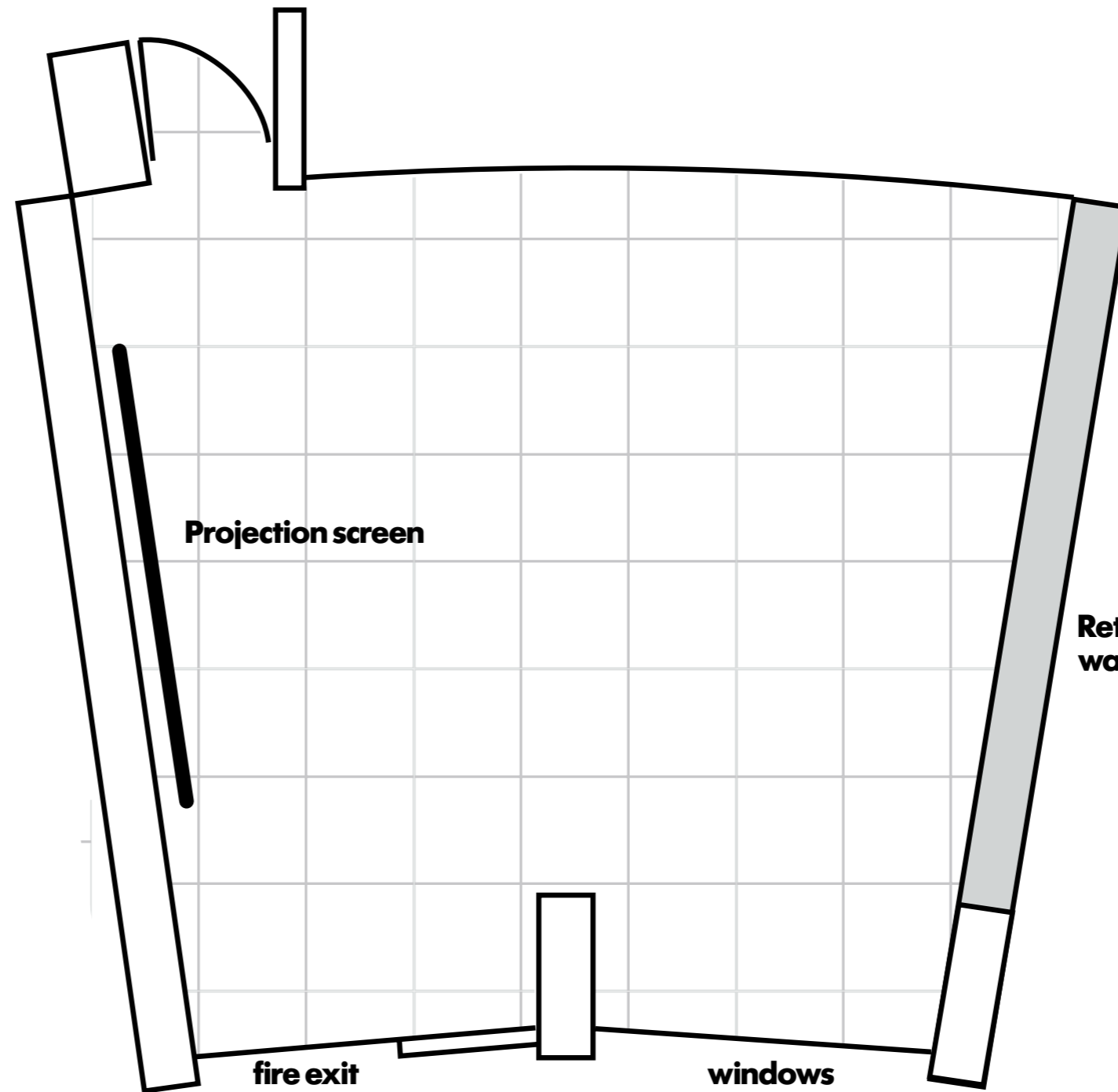

Theatre style

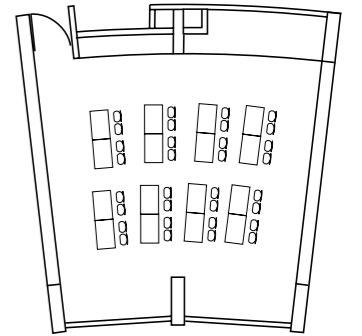

Classroom style

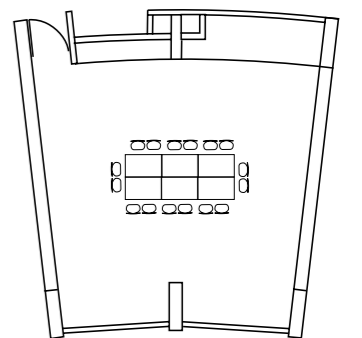

Boardroom style

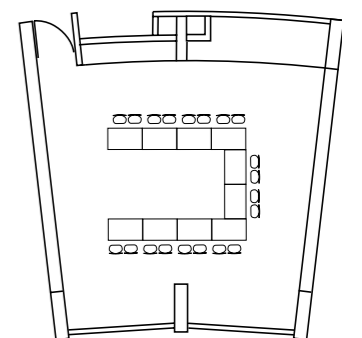

U-shape style

Frobisher Room Two rooms linked Level 4

Barbican Centre
Silk Street
London EC2Y 8DS
Tel +44 (0) 7382 7043
business.events@barbican.org.uk
www.barbican.org.uk

Capacity

| | |
|-----------------|---------|
| theatre style | 110 max |
| classroom style | 60 max |
| u-shape style | 44 max |
| cabaret style | 64 max |

Dimensions

| | |
|--------|----------------------------------|
| area | 144m ² (1,550 sq.ft.) |
| width | 8m (26'3") |
| length | 18m (59') |
| height | 4m (13'2") |

floor loading 100lbs/sq.ft.

Venue facilities

- free delegate wi-fi
- flown projector and screen 4x3m (13'x 9'8")
- natural daylight, blackout blinds, dimmable lighting and comfort cooling
- directional signage
- accessible via passenger lifts, stairs and goods lift
- frobisher rooms are all wheelchair accessible
- Standard 13 amp power (other power to quote)

Plan to be used as a guide only.
each grid square represents 1m² (approx).

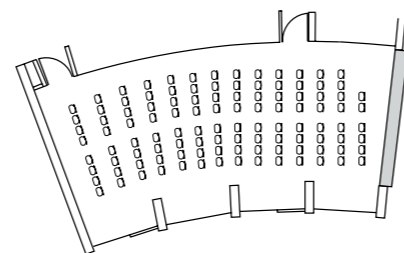
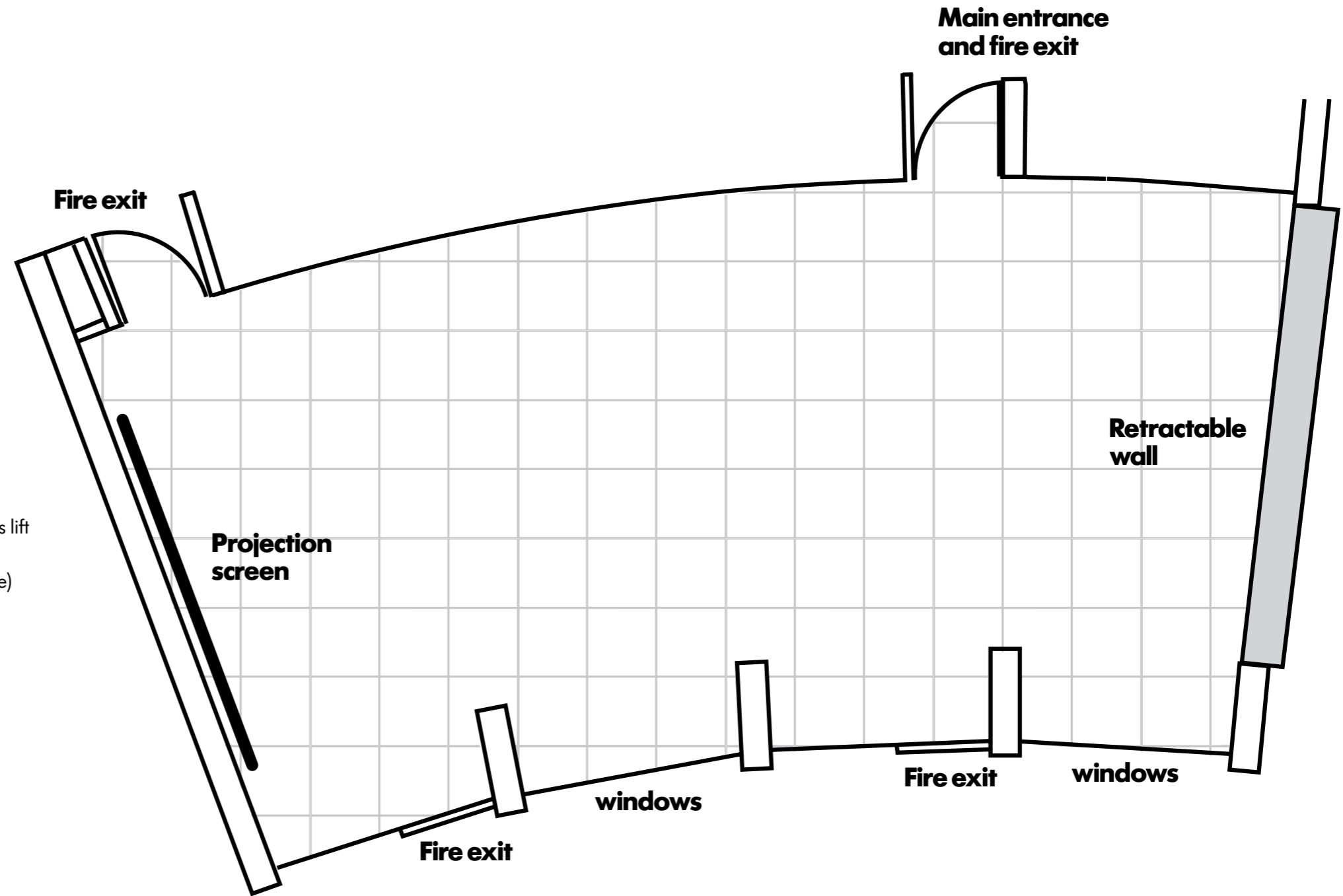

Theatre style

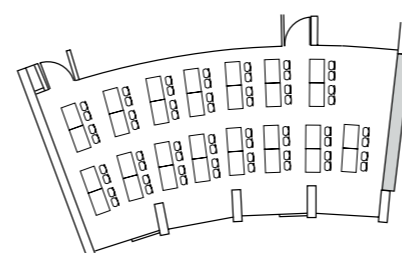

Classroom style

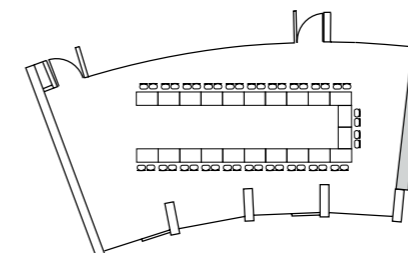

U-shape style

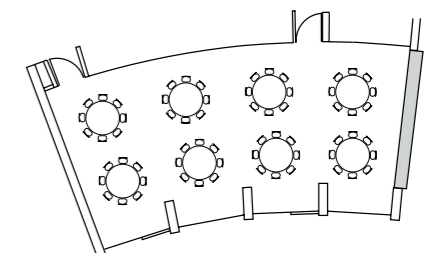

Cabaret style

Frobisher Room Three rooms linked Level 4

Barbican Centre
Silk Street
London EC2Y 8DS
Tel +44 (0) 7382 7043
business.events@barbican.org.uk
www.barbican.org.uk

Capacity

| | |
|-----------------|---------|
| theatre style | 170 max |
| classroom style | 100 max |
| cabaret style | 96 max |

Dimensions

| | |
|--------|----------------------------------|
| area | 216m ² (2,325 sq.ft.) |
| width | 8m (26'3") |
| length | 27m (88' 6") |
| height | 4m (13'2") |

floor loading 100lbs/sq.ft.

Venue facilities

- free delegate wi-fi
- flown projector and screen 4x3m (13'x 9'8")
- natural daylight, blackout blinds, dimmable lighting and comfort cooling
- directional signage
- accessible via passenger lifts, stairs and goods lift
- frobisher rooms are all wheelchair accessible
- Standard 13 amp power (other power to quote)

Plan to be used as a guide only.
each grid square represents 1m² (approx).

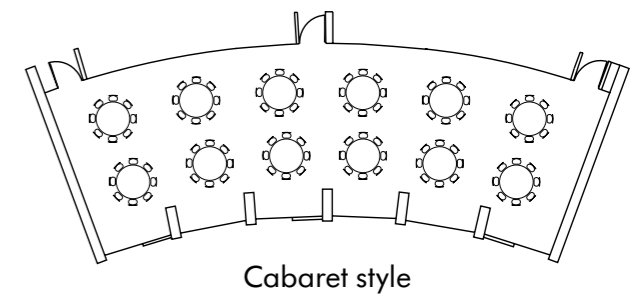
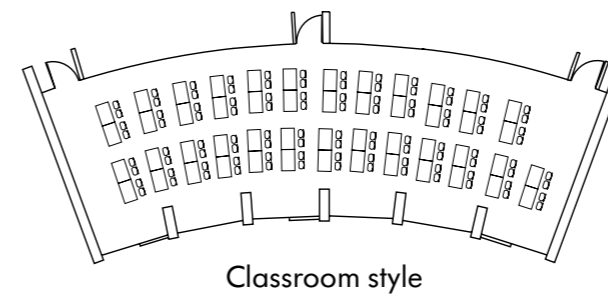
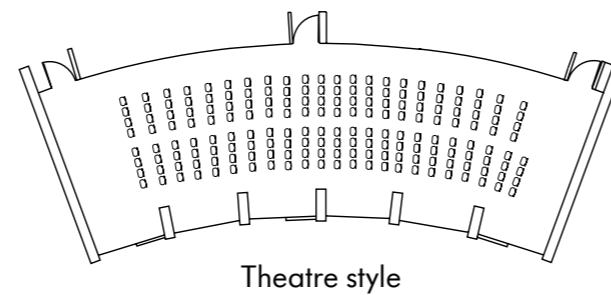
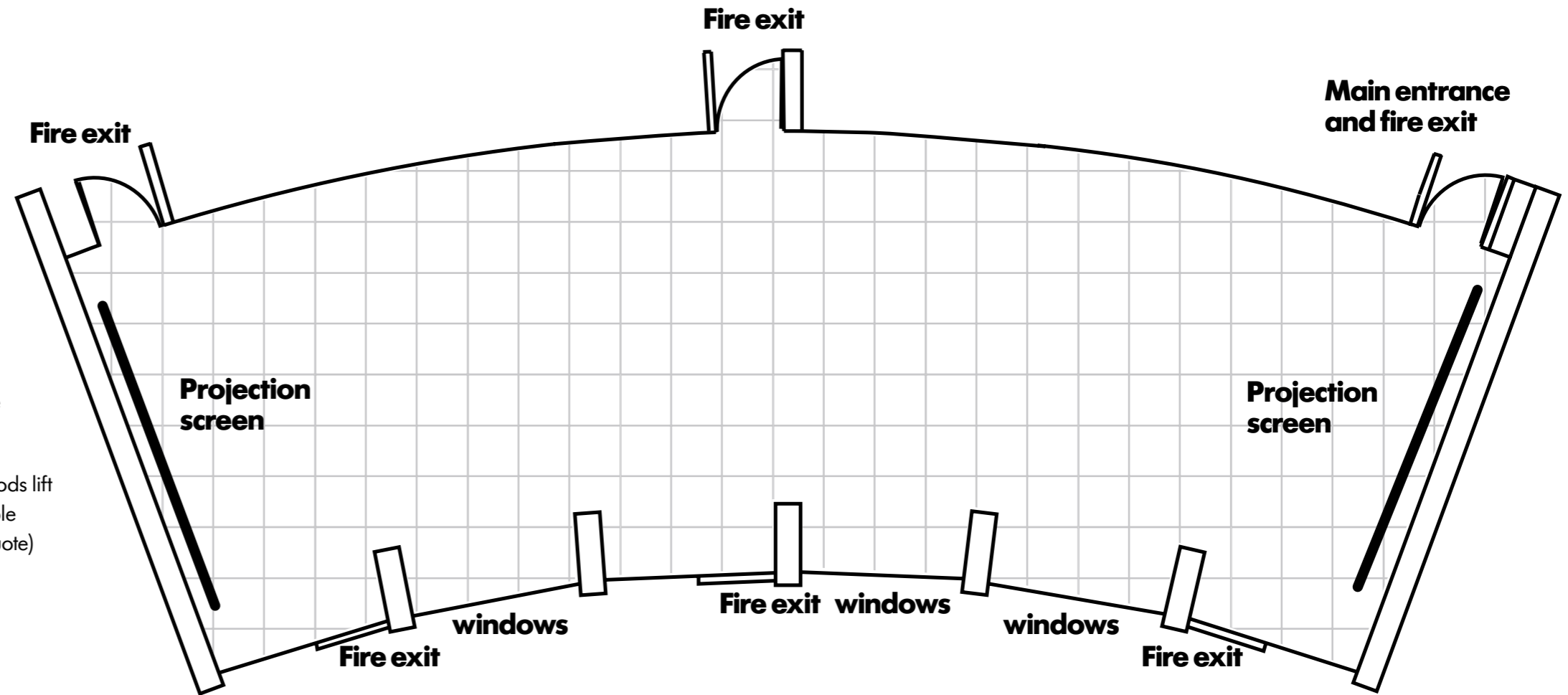

Frobisher Boardroom Level 4

Barbican Centre
Silk Street
London EC2Y 8DS
Tel +44 (0) 7382 7043
business.events@barbican.org.uk
www.barbican.org.uk

Capacity

boardroom 20 max

Dimensions

area 68m² (732 sq.ft.)
width 8m (26'3")
length 8.5m (27'11")
height 4m (13'2")

floor loading 100lbs/sq.ft.

Venue facilities

- free delegate wi-fi
- 80" LED screen
- dedicated boardroom table with leather armchairs
- natural daylight, blackout blinds, dimmable lighting and comfort cooling
- directional signage
- accessible via passenger lifts, stairs and goods lift
- wheelchair accessible
- USB charging points
- standard 13 amp power

Plan to be used as a guide only.
Each grid square represents 1m² (approx).

Main entrance and fire exit

