

Garden Room Level 3

Barbican Centre
Silk Street
London EC2Y 8DS
Tel +44 (0) 7382 7043
business.events@barbican.org.uk
www.barbican.org.uk

Capacities

standing reception 300
standing buffet 250
seated buffet 180
banquet 220
theatre style 150

Dimensions

available floor area 316m² (3,401 sq.ft)
width 16.6m (54'6")
length 24m (78'9")
max height 3m (9'10")
min height 2.5m (8'4")

Facilities

- free delegate wi-fi
- natural daylight, black out blinds
- LED colour changing ceiling panels
- suitable for music up to 95dB (by arrangement)
- comfort cooling
- goods lift access (8am–8pm)
- accessible via passenger lifts and stairs
- staffed cloakroom
- standard 13amp power (other power to quote)

Plan to be used as guide only.
Each grid square represents
1m² approx.

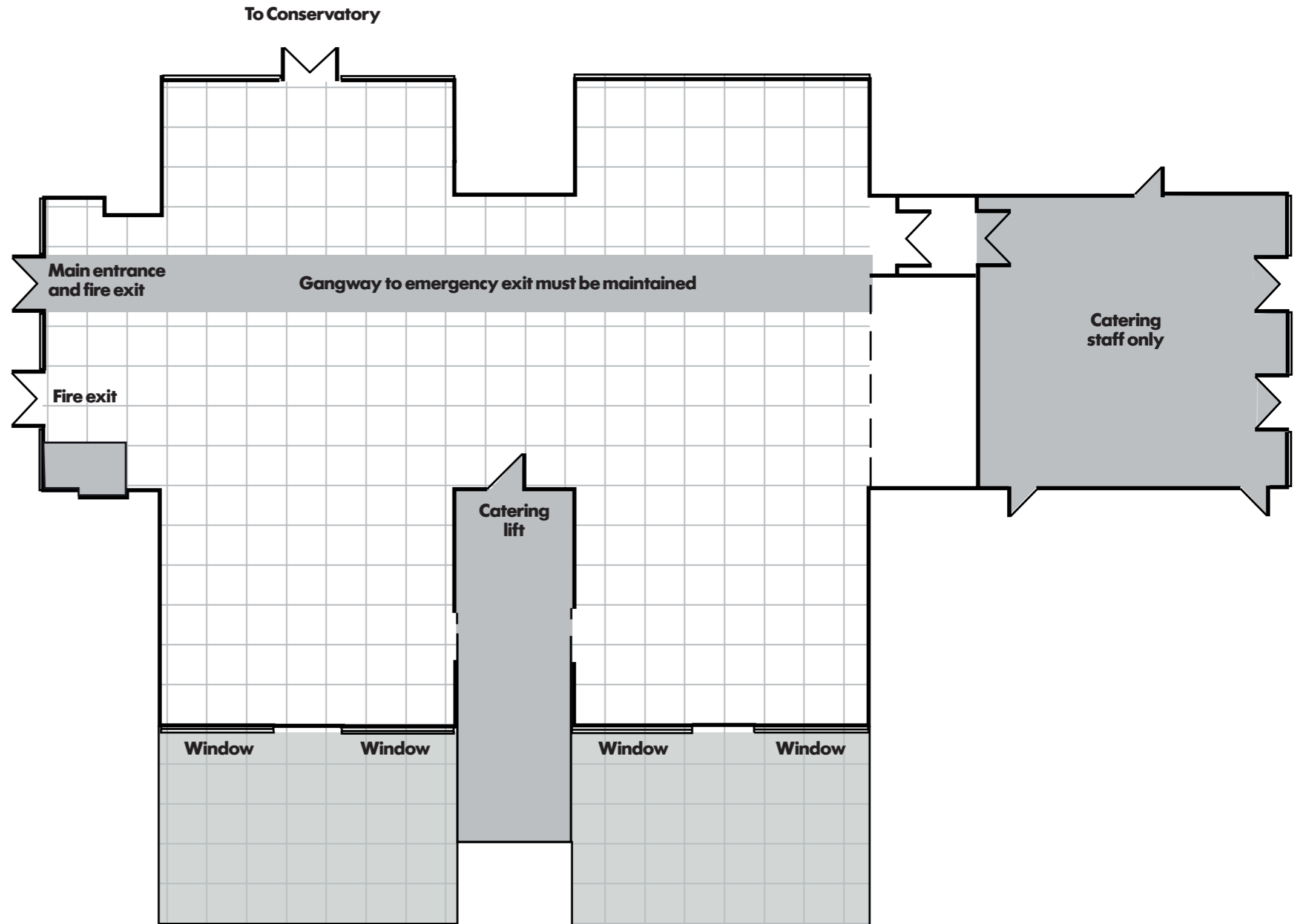

View of the Lakeside Terrace